



**IPOS 2023**  
WORLD CONGRESS



UNIVERSITÀ  
DEGLI STUDI  
DI MILANO



**MILAN, ITALY**  
AUGUST 31 - SEPTEMBER 3, 2023

24<sup>th</sup> IPOS World Congress of Psycho-Oncology



Società Italiana di Psico-Oncologia

## PROGRAMME

CHAMPIONING OUR PATIENTS' FUTURE THROUGH  
COLLABORATION AND INNOVATION IN PSYCHO-ONCOLOGY

# Welcome

Dear Colleagues and Friends,

We are very proud to be hosting the **24<sup>th</sup> World Congress of Psycho-Oncology 2023, 31st August – 3rd September 2023 in Milan, Italy**. We hope that you will join us in the beautiful city of Milan so that we will be able to share and compare our professional experiences with the goal of improving the care that our patients receive in their most vulnerable moments.

Our theme for the meeting is: **Championing our patients' future through collaboration and innovation in psycho-oncology.**

The congress has defined 5 goals: Innovation, education, equity, measuring efficacy, and sustainable psycho-oncology.

We will develop each of these goals keeping the focus on how these can be applied in each area. The needs of each individual patient and the support to offer to their immediate family, carers, and healthcare professional of reference, will be taken into consideration, as well as the gaps in care that need to be addressed.

As usual, we will be providing high level workshops on 31st August as part of the IPOS Psychosocial Academy. These will be held by leading international experts and will offer in depth training on various topics. The workshops will be available for various professionals that will include palliative and supportive care professionals as well as psycho-oncology researchers and specialists.

The IPOS World Congress has gained the title of being the best opportunity for providing the latest information and tools that enable everyone that is involved in psycho-oncology at all levels, to improve the level of information and daily care.

Milan is a vibrant and dynamic city, and we expect that the meeting will reflect this feeling. The opportunity to network and the possibility to make a difference to the lives of those that are entrusting us with their care is an honour and a responsibility. Let's work hard together to make a difference.

I look forward to welcoming you to my home city and spending productive time together.

Your sincerely,

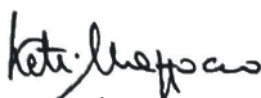

Ketti Mazzocco  
Chair, IPOS 2023



Thomas Hack  
Co-Chair, IPOS 2023





## Welcome from the IPOS President

Dear Friends and Colleagues,

On behalf of the International Psycho-Oncology Society (IPOS) it is my pleasure to welcome you to Milan for the 24th World Congress of Psycho-Oncology. This is the 2nd time the World Congress has been hosted in Italy, the first time in 2006 in Venice. This year IPOS has partnered with We Will Care, a non-profit organization focused on improving patients' programs. More information on We Will Care can be found by going to <http://www.wewillcare.it/>.

The theme for IPOS 2023 is **"Championing our Patients' Future Through Collaboration and Innovation in Psycho-Oncology."** Moreover, 5 goals have been defined as part of the theme: innovation, education, equity, measuring efficacy, and sustainable psychology. This Congress will give us the opportunity to make significant progress in psycho-oncology as we learn about innovative research in the field, while developing new research ideas and clinical innovations. We are thrilled to welcome delegates from more than 50 countries, coming together to collaborate, share and learn.

IPOS continues to advocate toward the adoption of our Standard of Quality in Cancer Care and Clinical Practice Guidelines which state:

1. Psychosocial cancer care should be recognized as a universal human right;
2. Quality cancer care must integrate the psychosocial domain into routine care;
3. Distress should be measured as the sixth vital sign after temperature, blood pressure, pulse, respiratory rate and pain.

By coming together we help further our effort toward ensuring psychosocial cancer care is recognized as a universal human right. This congress draws psycho-oncology world leaders together – leaders like yourselves who are passionate and committed to advancing psycho-oncology research, building capacity for cancer support services and ensuring the highest levels of standardized clinical practice. Enjoy this opportunity to build your professional networks.

As a society we are committed to fostering integration and implementation of psychosocial care globally. One way we have continued to do this is with our popular webcast series, free to current IPOS members, on a range of topics that support our members' search for knowledge. Since 2015, our global reach has increased significantly having almost tripled our membership numbers worldwide. However, there is still work to be done to ensure we continue to facilitate the development of strong, sustainable psycho-oncology programs around the world. I encourage you to get involved by joining our Societies' Committees, Special Interest Groups and Task Forces. Together our efforts are improving the quality of life of those affected by cancer.

With my gratitude and best wishes,

*Thomas Z. Hank*

President, International Psycho-Oncology Society



# International Scientific Committee

## Chair

Gabriella Pravettoni, University of Milan, Italy

## Co-chairs

Csaba L. Dégi, Babe-Bolyai University Cluj-Napoca, Romania

Luzia Travado, Champalimaud Centre, Lisbon, Portugal

## Members

Chioma Asuzu, Nigeria

Lea Baider, Israel

Marco Bellani, Italy

William S. Breitbart, US

Barry Bultz, Canada

Phyllis Butow, Australia

Miri Cohen, Israel

Giuseppe Curigliano, Italy

Cristiane Decat Bergerot, Brazil

Jayita Deodhar, India

Maria Die Trill, Spain

Tania Estapé, Spain

Lesley Fallowfield, UK

Clair Foster, UK

Daisuke Fujisawa, Japan

Luigi Grassi, Italy

Thomas Hack, Canada

Melissa Henry, Canada

Nick Hulbert-Williams, UK

Paul Jacobsen, US

Michael Jefford, Australia

Christoffer Johansen, Denmark

David Kissane, US

Wing Tak Wendy Lam, China

Matthew J. Loscalzo, US

Anja Mehnert, Germany

Alex J Mitchell, UK

Philip Odiyo Ouma, Kenia

Patricia Parker, US

Julia H. Rowland, US

Jane Turner, Australia

Marije van der Lee, The Netherlands

Maggie Watson, UK

## Thematic areas

1

Innovation

2

Education

3

Equity

4

Measuring Efficacy

5

Sustainable Psycho-Oncology

## Highlights

Survivorship and Quality of Life

New technologies (eHealth, mHealth, teleHealth, Predictive Models)

Engagement and adherence to cancer treatments

Health and disease in the carers

Cancer treatment-related symptoms and toxicity management

Palliative and end-of-life care



# Plenary Session Speakers

**Michael H. Antoni**

Professor of Psychology and Psychiatry and Behavioral Sciences Cooper Fellow, College of Arts and Sciences Cancer Control Program, Sylvester Comprehensive Cancer Center University of Miami

**Phyllis Butow**

Emeritus Professor in the School of Psychology, University of Sydney

**Andreas Charalambous**

ECO President and EONS Board member

**Steven W. Cole**

Professor of Psychiatry & Biobehavioral Sciences and Medicine in the Division of Hematology-Oncology, David Geffen School of Medicine at UCLA, Los Angeles

**Giuseppe Curigliano**

Director New Drugs and Early Drug Development for Innovative Therapies Division, European Institute of Oncology, Milan

**André Ilbawy**

Department of Universal Health Coverage, WHO

**Penilla Gunther**

Member EU Cancer Mission Board & Founder, FOKUS Patient

**Stella Kyriakides**

European Commissioner for Health and Food Safety

**Matthew Loscalzo**

Executive Director, People & Enterprise Transformation Emeritus Professor Supportive Care Medicine, Professor Population Sciences at the City of Hope

**Mike Morrissey**

ECO Chief Executive

**Ines Vaz-Luis**

Institut de Cancérologie Gustave Roussy, Paris

## Symposia and Oral presentations Speakers

Acquati Chiara	USA	Bovero Andrea	Italy
Acquaye-Mallory Alvina A.	USA	Bozicevic Laura	Australia
Alananzeh Ibrahim	UAE	Brajkovic Lovorka	Croatia
Amariutei Ana	Germany	Braun Sarah	USA
Ananeva Evgeniia	Russia	Braun Michal	Israel
Andersen Barbara	USA	Brunelli Cinzia	Italy
Anderson Kate	Australia	Buonaccorso Loredana	Italy
Armento Grazia	Italy	Butow Phyllis	Australia
Armes Jo	United Kingdom	Caldwell Phillips Brenda	United Kingdom
Armoogum Julie	UK	Carnevale Stefania	Italy
Armstrong Terri S.	USA	Caruso Rosangela	Italy
Arsenijevic Jelena	The Netherlands	Casali Paolo	Italy
Asuzu Chioma	Nigeria	Chan Julia	Hong Kong
Bahcivan Ozan	Turkey	Cheli Simone	Italy
Baider Lea	Israel	Chemrouk Yasmine	France
Banos-Lara Ma del Rocio	Mexico	Cheng Chihtao	Taiwan
Bányai Éva	Hungary	Chevalier Lydia	USA
Barsky Reese Jennifer	USA	Chiang Yung-Chih	Taiwan
Bartley Nicole	Australia	Chichua Miriam	Italy
Bazán-Muñoz Jorge	Mexico	Chidambaram Sundaramoorthy	India
Baziliansky Svetlana	Israel	Chieffo Daniela	Italy
Beatty Lisa	Australia	Chirico Andrea	Italy
Bedoya, PsyD Sima	USA	Chomistek Tessa	Canada
Beeken Rebecca J	UK	Chu Alanna K	Canada
Belella Daniela	Italy	Ciria-Suarez Laura	Spain
Bennett Audrey	Australia	Constantinidou Anastasia	Cyprus
Bernardi Evelina	Italy	Conti Lorenzo	Italy
Besani Chiara	Ireland	Cooke Samuel	United Kingdom
Bidstrup Pernille Envold	Denmark	Costas-Muniz Rosario	USA
Bilodeau Karine	Canada	Crawley Emma Louise	Italy
Biran Adam	United Kingdom	Criscitiello Carmen	Italy
Blankley Gaynor	Australia	Curigliano Giuseppe	Italy
Bleiker Eveline M.A.	The Netherlands	Custers José	The Netherlands
Bober Sharon	USA	Cuyper Maarten	The Netherlands
Body Anjelica	USA	Czamanski-Cohen Johanna	Israel
Bolanos Natacha	Canada	Dalton Susanne Oksbjerg	Denmark
Bologna Fabiola	Italy	Damaskos Penelope	USA
Bolognini Ida	Italy	D'Antona Rosanna	Italy
Bonandini Elisa	Italy	Davies Elizabeth	United Kingdom
Bonanno Marco	Canada	De Heus Eline	The Netherlands
Bonassi Lucia	Italy	de Korte Anne	The Netherlands
Bonifacino Adriana	Italy	De Lorenzo Francesco	Belgium
Bourdeau Camille	Canada	De Munter Johan	Belgium
Bourgeois Amber	Canada	De Rooij Belle H.	The Netherlands
Boven Charlotte	Belgium	De Vlaming Irene	The Netherlands

de Vries Froukje	The Netherlands	Guardamagna Vittorio	Italy
Degi Csaba	Romania	Guerin Suzanne	Ireland
Deledda Giuseppe	Italy	Hahlweg Pola	Germany
Denny Margaret	Slovenia	Hall Louise	United Kingdom
Didier Florence	Italy	Hamilton Jessica	USA
Dinapoli Loredana	Italy	Hammer Nanna Maria	Denmark
Dionigi Francesca	Italy	Hanalis-Miller Tsipi	Israel
Do Mai T.	Vietnam	Hasson-Ohayon Ilanit	Israel
Dorangricchia Patrizia	Italy	Hata Kotone	Japan
Driessen Helen	The Netherlands	Henry Melissa	Canada
Duijts Saskia A.	The Netherlands	Hersch Jolyn	Australia
Engelhardt Ellen	The Netherlands	Heuser Christian	Germany
Etapè Tania	Spain	Hiltrop Kati	Germany
Ezendam Nicole	The Netherlands	Hoeg Beverley Lim	Denmark
Farrugia Tamsin	Australia	Holzknicht Elisabeth	Italy
Fernandes Darren	United Kingdom	Horgan Denis	Belgium
Ferrari Andrea	Italy	Horrell Tara	Canada
Ferraris Giulia	Italy	Hu Yun	P.R China
Ferreri Andres	Italy	Hulbert-Williams Nicholas	United Kingdom
Figueiredo Patricia	Brazil	Huynh Jennie	United Kingdom
Filipponi Chiara	Italy	Ireland Alana	India
Fisher Abi	United Kingdom	Jacobson Lisa	USA
Fitch Margaret	Canada	Jaenke Rachael	Australia
Flix-Valle Aida	Spain	Jefford Michael	Australia
Folesani Federica	Italy	Jiboc Nicoleta-Monica	Romania
Foster Claire	United Kingdom	Joosen Margot	The Netherlands
Fotiadis Dimitrios	Greece	Juraskova Ilona	Australia
Galli Fabrizia	Italy	Kälin Sonja	Switzerland
Galvez-Hernandez Lizette	Mexico	Kane Ros	United Kingdom
Garcia-Torres Francisco	Spain	Kang Danbee	Republic of Korea
Garin Olatz	Spain	Kang Jiyeon	Republic of Korea
Garvey Gail	Australia	Karekla Maria	Cyprus
Gatti Pietro	Italy	Kelly Brian	Australia
Gibbons Felicity	United Kingdom	Kempe Samantha	Canada
Gidron Yori	Israel	Khalil Ielaf	Canada
Giesler Juergen M.	Germany	Kim Eun	Republic of Korea
Giguère Lauriane	Canada	Kim Sooyeon	Republic of Korea
Gitonga Isaiah	Ireland	King Amanda L.	USA
Goldzweig Gil	Israel	Kinnane Nicole	Australia
Gonella Marco	Italy	Kirsten Laura	Australia
Gopalakrishnan Vidhya	India	Klages Kimberly	USA
Göransson Patrik	Sweden	Knapp Peter	United Kingdom
Goswami Savita	India	Koczura Bogda	Australia
Grassi Luigi	Italy	Koeva Jasmina	Bulgaria
Grasso Roberto	Italy	Kolsteren Evie	The Netherlands
Greally Helen	Ireland	Kosugi Kazuhiro	Japan
Greidanus A. Michiel	The Netherlands	Kotwal Juee	USA
Grisolaghi Jacopo	Italy	Kovács Ágnes Anna	Hungary
Gritti Paolo	Italy	Kowalczyk Oliwia	Polonia

Kroll Juliet	USA	McPeake Kathie	United Kingdom
Lafuenti Letizia	Italy	Medina Joan Carles	Spain
Lai Yeur Hur	Taiwan	Mehnert-Theuerkauf Anja	Germany
Lai-Kwon Julia	Australia	Mendes-Santos Cristina	Portugal
Lam Wendy Wing Tak	Hong Kong, China	Merluzzi Thomas	USA
Lamarche Jani	Canada	Michel Gisela	Switzerland
Le Phuong Thao D	USA	Milani Alessandra	Italy
Lebel Sophie	Canada	Milbury Kathrin	Texas
Lee Genehee	Republic of Korea	Miles Anne	United Kingdom
Lehmann Vicky	The Netherlands	Milzer Marlena	Germany
Lemeng Zhang	P.R. China	Monzani Dario	Italy
Lemmen J.P.M.	The Netherlands	Mor Yair	Israel
Leske Morgan	Australia	Morris-Baguley Harriet	Australia
Lietaviete Inese	Latvia	Morton Kate	United Kingdom
Liu Yanyan	China	Mullen Louise	Ireland
Liu Feng	P.R. China	Myers Charlotte	Ireland
Liu Xiaohong	P.R. China	Nekhlyudov Larissa	USA
Lo Dato Federica	Italy	Nelson David	United Kingdom
Lone Irfan	Belgium	Nelson Christian	USA
Long Roisin	Ireland	Neri-Flores Veronica	Mexico
Loscalzo Matthew	USA	Neylon Karen	Ireland
Loughan Ashlee	USA	Ng Danielle Wing Lam	Hong Kong
Lounsbury David	USA	Nguyen Tien Van	Vietnam
Luciani Maria Novella	Italy	Nissim Rinat	Canada
Lugtenberg Marjolein	The Netherlands	Normen Michelle	India
Lunt Vicky	Ireland	Northman Lisa	USA
Lynch Fiona	Australia	O'Neill Olive	Ireland
Maas Anne	The Netherlands	Ochoa-Arnedo Cristian	Spain
Machiavelli Aline	USA	Oerlemans Simone	The Netherlands
Magalhaes Mona	Canada	Oliveira Ana F.	Portugal
Maheu Christine Christine	Québec	Oliveri Serena	Italy
Mancuso Anna Maria	Italy	O'Loughlin Bernie	Ireland
Manduchi Beatrice	Canada	O'Meara Yvonne	Ireland
Mapayi Boladale	Nigeria	Ongaro Giulia	Italy
Markham-Jones Helene	United Kingdom	Onyedibe Maria-Chidi Christiana	Germany
Martin Michelle	USA	Ostroff Jaime	USA
Martinez Tyson Dinorah	USA	Panjwani Aliza	Canada
Marzorati Chiara	Italy	Paredes Martha	Peru
Masiero Marianna	Italy	Parker Patricia	USA
Matheson Lauren	United Kingdom	Parkinson Maureen	Canada
Mazariego Carolyn	USA	Paul Verena	Germany
Mazzocco Ketti	Italy	Pawelczak-Szastok Marta	Poland
Mazzurco Olivia	Canada	Peccatori Fedro	Italy
McDonald Geraldine	Australia	Pezzolato Massimo	Italy
McDonald Kaelyn	Canada	Piattelli Angela	Italy
McFadden Kathleen	Australia	Pichler Theresia	Germany
McFarland Daniel	USA	Porro Bertrand	France
McGeagh Lucy	United Kingdom	Pravettoni Gabriella	Italy
McInerney Daisy	United Kingdom	Ramirez-Orozco Monica	Mexico



Recklitis Christopher	USA	Tang Woung Ru	Taiwan
Rhodewalt Lauren	USA	Taub Chloe	USA
Riba Michelle	USA	Taylor Carolyn	USA
Rigney Maureen	USA	Taylor Rachel	United Kingdom
Rimmer Ben	United Kingdom	Thomas Mareike	Germany
Rini Christine	USA	Thomson Maria	USA
Robichaud Lye-Ann	Canada	Thornton Clifton P.	USA
Robinson Olivia Claire	United Kingdom	Tock Wing Lam	Canada
Rowland Julia	USA	Tong Fei	P.R. China
Ruble Kathy	USA	Torres Ana	Portugal
Ruda Lourdes	Peru	Torta Riccardo	Italy
Russell Lahiru	Australia	Travado Luzia	Portugal
Sacco Gaia Giulia Angela	Italy	Tremblay Dominique	Canada
Sala Diana	Italy	Trifirò Ilenia	Italy
Sanchini Virginia	Italy	Tsiouris Kostas	Greece
Sanctorum Katelijne	Belgium	Tubtimhin Sopit	Thailand
Sauer Christina	Germany	Vagnini Denise	Italy
Scaglioni Giulia	Italy	Van den Bulcke Marc	Belgium
Schellekens Melanie	The Netherlands	Van den Cruyce Nele	Belgium
Schnaitmann Natale	USA	Van der Lee Marije	The Netherlands
Scholl Isabelle	Germany	van der Wolf Pascale	The Netherlands
Scotto Ludovica	Italy	Veeraiah Surendran	India
Sebri Valeria	Italy	Vehling Sigrun	Germany
Segatti Anna	Italy	Vera Elizabeth	USA
Serpentini Samantha	Italy	Versluis Moyke A. J.	The Netherlands
Serra-Blasco Maria	Spain	Vickery Jessica	Canada
Sharp Linda	United Kingdom	Vienne (PhDs) Juliana	France
Sharpe Louise	Australia	Vlooswijk Carla	The Netherlands
Shaw Joanne	Australia	Vokinger Anna Katharina	Switzerland
Shinn Eileen	USA	Voskanyan Viktorya	Italy
Simonetti Alessio	Italy	Walbaum Charlotte	Germany
Singh Mina	Canada	Wamaloon Chaliya	Thailand
Skrypets Tetiana	Italy	Wandke Svenja	Germany
Smith Allan 'Ben'	Australia	Wang Yueh-Hsin	United Kingdom
Snyder Stella	USA	Warquier Pauline	Belgium
Søby Anne Katrine Hartmann	Denmark	Warwick Lorna	Canada
Spada Gea	Italy	Wasserman Sydney	Canada
Springer Franziska	Germany	Watson Emily	United Kingdom
Stark Daniel	United Kingdom	Watson Maggie	United Kingdom
Stoica Lydia	Romania	Webb Kyra	Australia
Stoll Lara	Australia	Webster Rachel	USA
StuiverMartijn	The Netherlands	Wein Simon	Israel
Subathra Jeyaram	Bahrain	Weis Joachim	Germany
Sudhakar Revathy	India	Weissflog Gregor	Germany
Sultan Serge	Canada	Wells Elizabeth	Australia
Suvaal Isabelle	The Netherlands	Wettergren Lena	Sweden
Syska-Bielak Anna	Poland	Whisenant Meagan	USA
Tack Laura	Belgium	White Victoria	Australia
Takeuchi Emi	Japan	Winterling Jeanette	Sweden

Witte Vanessa	Germany	Zaparoli de Oliveira Giovana	Brazil
Wuensch Alexander	Switzerland	Zegers Amber Danielle	The Netherlands
Yang Desong	P.R. China	Zhan Ze-jiang	P.R. China
Yeung Nelson	P.R. China	Zhang June	P.R. China
Youngmee Kim	USA	Zhou Ran	P.R. China
Yu Ally	Canada	Zucchetti Giulia	Italy
Zaiac Michael	Switzerland	Zwanenburg L.C.	The Netherlands

## Psycho-social Academy Speakers

Baider Lea	Israel	Loscalzo Matthew	USA
Besani Chiara	Ireland	Mai Peter	Germany
Bultz Barry	Canada	McGee Lori	USA
Cincidda Clizia	Italy	Moraru Camelia	Romania
Crico Chiara	Italy	Nappi Rossella	Italy
Deledda Giuseppe	Italy	Oprea Mara	Romania
de Vlaming Irene	The Netherlands	Preti Eleonora	Italy
Didier Florence	Italy	Rowland Julia	USA
Dupont Bonnie	Canada	Sanchini Virginia	Italy
Fantoni Giovanna	Italy	Scotto Ludovica	Italy
Fournier Valentyn	France	Serpentini Samantha	Italy
Giommi Fabio	The Netherlands	Taal Jan	The Netherlands
Greally Helen	Ireland	Tanzi Silvia	Italy
Hughes Mary	USA	Toma Camelia	Romania
Kingsberg Sheryl	USA	Udrea Iulia	Romania
Labo Cristina	Romania	Van der Lee Marije	The Netherlands
Lamore Kristopher	France	Zucchi Giovanni	Italy

# PSYCHO-SOCIAL ACADEMY

## AUGUST 31

08.00

### REGISTRATION FOR THE WORKSHOPS

H.

09.00

-

12.30

#### ROOM 208

In Pursuit of Sustainable Support: Who Pays for the Psychosocial Care you Provide—and Why?

*Julia Rowland, Barry Bultz, Matthew Loscalzo, Bonnie DuPont, Lori McGee*

#### ROOM 211

Methodological guidelines to develop and evaluate an intervention in psycho-oncology  
*Kristopher Lamore, Valentyn Fournier*

#### ROOM 304

ITALIAN: Prendersi cura di ciò che non hai scelto: il modello Acceptance and Commitment Therapy (ACT) applicato in ambito oncologico.

*Giuseppe Deledda, Giovanna Fantoni, Giovanni Zucchi*

#### ROOM 309

Acknowledging and Addressing sexuality issues of patients with cancer including LGBTQI+  
*Mary K. Hughes, Samantha Serpentine*

#### ROOM 422

Providing personalized psychosocial support based on Early Maladaptive Schemas  
*Marije van der Lee, Irene de Vlaming*

#### ROOM 435

Ethical Issues In Oncology. Moral Conflicts, Healthcare Professionals' Distress, Vulnerability, And Support Services

*Clizia Cincidda, Virginia Sanchini, Chiara Crico, Silvia Tanzi*

#### ROOM 515

Co-creating safe emotional and psychological sharing spaces using collage as artistic expression

*Iulia Udrea, Mara Oprea, Camela Moraru, Camelia Toma, Cristina Labo*

#### ROOM MALLIANI

Psychosocial Interventions For Elderly Patients With Cancer Illness  
*Lea Baider*

12.30



Lunch

H.

13.30

-

17.00

**ROOM 302**

Expressive Arts Therapy Interventions for relieving emotional and physical suffering in cancer patients

*Peter Mai*

**ROOM 304**

Full day: to be continued

**ROOM 309**

Development of a National Model of Care for Psycho-Oncology services in Ireland for Children Adolescents and Young Adults (CAYA) with Cancer (0-24yrs)

*Chiara Besani, Helen Greally*

**ROOM 435**

Imagery and non-verbal interventions to cope with fear of disease recurrence and fear of death

*Jan Taal*

**ROOM MALLIANI**

Sex and Cancer: what can we do?

*Ludovica Scotto, Rossella Nappi, Sheryl Kingsberg (video connected), Eleonora Petra Preti, Florence Didier, Fabio Giommi*

16.00-17.00

**REGISTRATION OPEN FOR THE IPOS CONGRESS**

# SEPTEMBER 1

7.30

Registrations

8.30

## PLENARY SESSION

### AULA MAGNA

Welcome to the 24th World Congress of Psycho-oncology

Ketti Mazzocco, Congress Chair

Tom Hack, Congress Chair and IPOS President

H.

09.00

-

10.00

### AULA MAGNA

#### Survivorship and quality of life

Moderator: Michelle Martin

09.00-09.20: Return to work and work productivity loss in Chinese breast cancer patients after the first two years post-surgery: a longitudinal study

Danielle Ng Wing Lam

09.20-09.40: Mental health in prostate cancer patients: results from EUROPROMS study (Europa Uomo Patient Reported Outcome Study)

Tania Estapé

09.40-09.50: To Gain an In-depth Understanding of Colorectal Cancer Survivor Follow Up: A qualitative interview study

Darren Fernandes

09.50-10.00: Q&amp;A

### ROOM 113

#### Environment, equity and economy

Moderator: Alessandra Milani

09.00-09.20: The impact of mental disorders on breast cancer screening in Taiwan

Yueh-Hsin Wang

09.20-09.40: Socioeconomic differences in health-related quality of life among cancer survivors and comparison with a cancer-free population: a PROFILES study

Simone Oerlemans

09.40-09.50: A rapid systematic review exploring the qualitative experiences of people living with lung cancer in rural and remote areas

Samuel Cooke

09.50-10.00: Q&amp;A



H.

09.00

-

10.00

**ROOM 201****Cancer treatment-related symptoms and toxicity management**

Moderator: Beverley Lim Hoeg

09.00-09.20: Sexual functioning and information needs of survivors with an ovarian tumor and their partner compared to the general population: results from the PROFILES registry  
Nicole Ezendam

09.20-09.40: Effects of the REBECCA Nurse-navigation intervention targeting vulnerable breast cancer patients: A Randomized controlled trial  
Pernille Envold Bidstrup

09.40-09.50: Exploring non-central nervous system cancer survivors' access, acceptability, and expectations regarding interventions for cognitive complaints  
Ana F. Oliveira

09.50-10.00: Q&A

**ROOM 208****New technologies**

Moderator: Ilaria Durosini

09.00-09.20: Evaluating therapy optimisation processes in psycho-oncology videotherapy  
Emily Watson, Felicity Gibbons

09.20-09.40: Committed Couples Remote Simultaneous Electronic Screening for Perception of Cancer Prognosis Before the Physician Visit  
Matthew Loscalzo

09.40-09.50: "Nothing about me without me" The key to successfully developing an online platform for those impacted by gynaecological cancer is early patient and public involvement  
Yvonne O'Meara

09.50-10.00: Q&A

**ROOM 211****Survivorship and quality of life**

Moderator: Chiara Marzorati

09.00-09.10: The silent epidemic of suicide and suicidal ideation in patients with nasopharyngeal carcinoma: An in-depth analysis of 15305 patients from the US and China  
Ze-Jiang Zhan

09.10-09.20: Somatic symptoms and mental adjustment to cancer: a cross-sectional study on oncology patients in Romania  
Lidia Stoica

09.20-09.30: Writing a Life  
Lauren Rhodewalt

H.

09.00

-

10.00

09.30-09.50: Activity and participation of childhood cancer survivors during the process of reintegration into everyday life- results from a qualitative study  
Verena Paul

09.50-10.00: Q&A

### ROOM 302

#### Assessment instruments and research methods in cancer care

Moderator: Milija Strika

09.00-09.10: Psychological assessment of patient with pancreatic cancer  
Daniela Belella

09.10-09.20: Measuring Fear of Cancer Recurrence in Patients with Primary Brain Tumors  
Sarah Braun

09.20-09.30: Development of key principles and best practice approaches to co-design with First Nations peoples applicable to the cancer context in Australia  
Kate Anderson

09.30-09.40: Intensity of mental health treatment of cancer-related psychopathology: the predictive role of early maladaptive schemas  
Irene De Vlaming

09.40-09.50: The critical role of social components of distress in cancer patients: A network analysis of distress and resilience factors with implications for assessment and intervention  
Andrea Chirico

10.20-10.30: Q&A

### ROOM 304

#### Palliative and end-of-life care - Environment, equity and economy

Moderators: Samantha Serpentine/Mary Hughes

09.00-09.10: Quality of Death in Hospital and Bereavement Outcomes in the COVID-19 era  
Rinat Nissim

09.10-09.30: Health professionals and volunteers views and experiences of delivering bereavement care  
Nicole Bartley

09.30-09.50: State of Psycho-Oncology and Palliative Care in African National Cancer Control Plans: Initial Analysis Towards Creating a Blueprint of Essential Elements to Implement Broadly in Africa  
Melissa Henry

09.50-10.00: Q&A

H.

09.00

-

10.00

**ROOM 309****Implementation science****Moderator:** Carolyn Mazariego

09.00-09.10: Developing a Patient Experience Strategy in partnership with patients, families and carers in a Comprehensive Cancer Centre  
Geraldine McDonald

09.10-09.20: Developing a 'living with cancer' programme in a rural setting: experiences of collaborative and innovative co-production working across an Integrated Health System  
Kathie McPeake

09.20-09.30: Implementation of a referral pathway for cancer survivors to access allied health services in the community  
Lahiru Russell

09.30-09.40: Information and support centers for patients with cancer: what is the added value?  
Helen Driessen

09.40-09.50: The efficacy of Brief Strategic Therapy in the psychological treatment of Generalized Anxiety Disorder in a group of Italian cancer patients  
Jacopo Grisolaghi

09.50-10.00: Q&A

**ROOM 311****Health promotion and cancer prevention****Moderator:** Mona Magalhaes

09.00-09.20: Perioperative individually-tailored psychological intervention in breast cancer patients reduces psychological distress and improves molecular indices of metastasis in excised tumors  
Tsipi Hanalis-Miller

09.20-09.40: Men's adherence to cascade screening for BRCA1/2: which psychological factors are involved?  
Giulia Ongaro

09.40-10.00: Q&A

**ROOM 422****Ethics and decision making in cancer care****Moderator:** Marianna Masiero

09.00-09.10: Decision making about surgery among people treated for rectal cancer.  
Anne Miles

09.10-09.30: The journey of patients in cancer clinical trials: a qualitative meta-synthesis on experiences and perspectives  
Mariam Chichua

H.

09.00

-

10.00

SEPTEMBER 1

09.30-09.50: Exploring needs and preferences of non small lung cancer patients during medical consultations: a focus group study within I3LUNG project

Patrizia Dorangricchia

09.50-10.00: Q&A

### ROOM 433

#### Intervention models for specific cancer types

Moderator: Paolo Guidi

09.00-09.20: Prehabilitation for patients receiving radiation therapy with a face mask

Jeyaram Subathra

09.20-09.30: Monitoring psychological distress and anxiety in gynecological cancer patients undergoing interventional radiotherapy applying HAPPY (Humanity Assurance Protocol in Interventional Radiotherapy) protocol

Loredana Dinapoli

09.30-10.00: Q&A

### ROOM 435

#### Engagement and adherence to cancer treatments

Moderator: Fedro Peccatori

09.00-09.10: Development of HT&Me, a blended supported self-management intervention to support adherence to endocrine therapy in women with breast cancer

Lucy McGeagh

09.10-09.20: Interventions to increase adherence to oral therapies in breast cancer patients: a systematic review based on the Behavior Change Technique Taxonomy

Massimo Pezzolato

09.20-09.30: Impact of a web-based self-management adherence intervention on global and emotional swallowing function in throat cancer patients

Eileen Shinn

09.30-09.50: The Impact of the SARS-CoV-2 Outbreak on the Psychological Flexibility and Behaviour of Cancelling Medical Appointments of Italian Patients with Cancer

Giuseppe Deledda

09.50-10.00: Q&A

### ROOM 515

#### Health and disease in the people who care

Moderator: Isabelle Scholl

09.00-09.20: The impact of maternal diagnosis of cancer on adolescents' psycho-social development.

Laura Bozicevic

H.

09.00

-

10.00

09.20-09.40: Professional grief in cancer care – A scoping review  
Svenja Wandke

09.40-09.50: "A constant black cloud" The emotional impact of informal caregiving for low-grade glioma patients  
Ben Rimmer

09.50-10.00: Q&A

### ROOM 517

#### AYA issues and interventions addressing their needs

Moderator: Helene Markham-Jones

09.00-09.20: Evolving support to complement evolving care: Developing an advance care planning guide for seriously ill adolescents and young adults  
Sima Bedoya, PsyD

09.20-09.30: Evaluation of psychological distress in adolescents and young adults (AYA) with cancer referred to Psycho-Oncology services in a tertiary care cancer centre.  
Savita Goswami

09.30-09.40: Neonatal and childhood outcomes of offspring of adolescent and young adult female cancer survivors: a national population-based study.  
Kang Danbee

09.40-09.50: Using a self-determination theory-based intervention to promote autonomous motivation for physical activity among young adults newly diagnosed with lymphoma: Result of a pilot randomized controlled trial  
Wing Lam Tock

09.50-10.00: Q&A

10.00



Break and poster discussion



10.30

**PLENARY SESSION****AULA MAGNA**

Chair: Csaba Degi, Michael Jefford

Cancer Policies

"Mental health matters: integrating psycho-oncology in the Beating Cancer Plan"

**Stella Kyriakides**

(SPECIAL RECORDED MESSAGE)

Round table:

- **Mike Morrissey**
- **Penilla Gunther**
- **André Ilbawi** (VIRTUALLY CONNECTED)

H.

11.30

-

13.00

**AULA MAGNA****SYMPOSIUM**

11.30-13.00: Stop reinventing the wheel! Adapting evidence-based digital interventions to different settings & populations: lessons from the Finding My Way program of research

*Chair: Lisa Beatty*

*Speakers: Bogda Koczwara, Nicholas J Hulbert-Williams, Lisa Beatty*

**ROOM 113****SYMPOSIUM**

11.30-13.00: How is cancer care provided to patients in English prisons? Assessing the disease burden in the prison population, experiences of receiving and providing cancer care

*Chair: Rachel Taylor*

*Speakers: Elizabeth Davies, Jennie Huynh, Jo Armes*

**ROOM 201****SYMPOSIUM**

11.30-13.00: The development of Paediatric Psycho-Oncology in Ireland: from the implementation of international standards of care to the innovation in therapeutic interventions

*Chair: Chiara Besani*

*Speakers: Roisin Long, Chiara Besani, Olive O'Neill*

**ROOM 208****SYMPOSIUM**

11.30-13.00: Unifying diversity in dying: Quality of death and dying in collectivistic and diverse cultures

*Chair: Surendran Veeraiah*

*Speakers: Subathra Jeyaram, Revathy Sudhakar, Michelle Normen*

**ROOM 211****SYMPOSIUM**

11.30-13.00: Sexual Health after Cancer: Challenges and Next Steps for Recovery

*Chair: Sharon Bober*

*Speakers: Sharon Bober, Jennifer Barsky Reese, Lena Wettergren*

H.

11.30

-

13.00

**ROOM 302****SYMPOSIUM**

11.30-13.00: Risk-predictive models of adherence to oral anticancer treatments in metastatic breast cancer patients: mechanisms behind non-adherence and personalized risk strategies

*Chair: Virginia Sanchini*

*Speakers: Gea Spada, Aline Machiavelli, Marianna Masiero*

**ROOM 304****SYMPOSIUM**

11.30-13.00: Clinical and relational issues of adolescent with cancer: breaking barriers and improving communications

*Chair: Fedro Peccatori*

*Speakers: Fedro Peccatori, Dan Stark, Ketti Mazzocco, Lea Baider, Ana Amariutei, Andrea Ferrari, Johan de Munter*

**ROOM 309****SYMPOSIUM**

11.30-13.00: Living with advanced cancer with a long-term response to novel therapies: strategies for coping with uncertainty

*Chair: Melanie P.J. Schellekens*

*Speakers: Julia Lai-Kwon, Laura C. Zwanenburg, Fiona A. Lynch*

**ROOM 311****SYMPOSIUM**

11.30-13.00: Unmet needs, quality of life and healthy life expectancy of rare cancer patients and survivors

*Chair: Saskia F.A. Duijts*

*Speakers: Saskia F.A. Duijts, Tamsin Farrugia, Eline de Heus*

**ROOM 422****SYMPOSIUM**

11.30-13.00: Cancer and Work: Resources and tools available to assist with return to work and maintenance of work for cancer survivor

*Chair: Tania Estapé*

*Speakers: Maureen Parkinson, Christine Maheu, Mina Singh*

**ROOM 433****SYMPOSIUM**

11.30-13.00: Turning intentions into action for the uptake of Next Generation Sequencing – The unmet need of Psycho-Oncology

*Chair: Denis Horgan*

*Speakers: Francesco De Lorenzo, Gabriella Pravettoni, Marc Van den Bulcke, Daniela Chieffo, Pietro Gatti*

**ROOM 435****SYMPOSIUM**

11.30-13.00: Improved psychosocial outcomes are related to the frequency and quality of communication between patients with lymphoma and their treating physicians

*Chair: Natacha Bolanos*

*Speakers: Tetiana Skrypets, Andres Ferreri, Lorna Warwick*

H.

11.30

-

13.00

**ROOM 515**

## SYMPOSIUM

11.30-13.00: Cancer and severe mental illness: a challenge for psycho-oncology

*Chair: Michelle Riba**Speakers: Luigi Grassi, Daniel McFarland***ROOM 517**

## SYMPOSIUM

11.30-13.00: Advancing Psycho-Oncology Programs in LMICs through Implementation

Science: A Case Study of Viet Nam

*Chair: PhuongThao Le**Speakers: Carolyn Taylor, Mai T. Do, Tien Van Nguyen*

13.00



Lunch and poster discussion

14.00

**PLENARY SESSION****AULA MAGNA**

Chair: Luzia Travado

New technologies in Widening the Scope and Increasing the Reach of Stress Research and Stress Management Interventions in Cancer Patients

**Michael H. Antoni**

15.00



Break and poster discussion

H.

15.30

-

17.00

**AULA MAGNA**

## SYMPOSIUM

15.30-17.00: Ovarian Cancer and Fear of Cancer Recurrence and Progression; Nuance, Collaboration and Future Intervention Pathways within a complex disease trajectory

*Chair: Louise Sharpe**Speakers: Audrey Bennett, Joanne Shaw, Ben Smith***ROOM 113****Cultural issues and international collaborations***Moderator: Lea Baider*15.30-15.50: "I knew I would get cancer": Family as a core factor of existential distress in women patients with advanced breast cancer in South Korea  
Jiyeon Kang15.50-16.10: Everywhere is local: Applying lessons from the community to areas across the globe  
Maureen Rigney16.10-16.30: Is it all Cultural? A Comparative Study of Depression, Hope, and Social Support among Older Muslim Palestinian and older Jewish Israeli Cancer Patients in Israel and the Palestinian authority  
Gil Goldzweig

H.

15.30

-

17.00

16.30-16.50

Pilot Testing of an Empathic Communication Skills Training Intervention to Reduce Lung Cancer Stigma in Nigeria

Boladale Mapayi

16.50-17.00: Q&amp;A

**ROOM 201****Caregivers' needs and interventions addressing them**

Moderator: Anne Maas

15.30-15.40: Development and Implementation of a Technology-based Psychoeducational Intervention for Cancer Caregivers

Denise Vagnini

15.40-15.50: Existential distress among caregivers of patients with advanced cancer: a systematic review and meta-analysis

Charlotte Walbaum

15.50-16.10: Understanding caregiver fear of cancer recurrence: a qualitative interview study to inform a caregiver specific FCR model

Joanne Shaw

16.10-16.30: Caregiver Health Outcomes Overtime: Differences By Role, Sex and Task

Maria Thomson

16.30-16.50: Development of a conceptual model of caregiver fear of cancer recurrence

Kyra Webb

16.50-17.00: Simulation-Based Caregiving Skills Training for Family Members of High-Grade Glioma Patients

Meagan Whisenant

**ROOM 208****Survivorship and Quality of Life**

Moderator: Matthew Loscalzo

15.30-15.40: If you build it will they come? Recruitment of diverse cancer survivors to a diet and exercise trial.

Michelle Martin

15.40-15.50: COVID-19, breast cancer care, and social determinants of health: a cross-sectional study to investigate the impact of a pandemic on health and health care

Charlotte Myers

15.50-16.00: How Cancer Survivors' Challenges After Treatment Impact Transition to Primary Care-led Follow-up Care

Jessica Vickery

16.00-16.10: Effects of cognitive behavioural therapy and nutritional counselling on the quality of life of breast cancer patients in the south-west, Nigeria

Chioma Asuzu

H.

15.30

-

17.00

16.10-16.20: Associated factors to fear of recurrence and quality of life in mexican breast cancer survivors

Monica Ramirez-Orozco

16.20-16.30: Evaluation of a specialist nurse-led survivorship consultation in an Australian gynae-oncology service

Nicole Kinnane

16.30-17.00: Q&A

### ROOM 211

#### Survivorship and Quality of Life

Moderator: Diana Sala

15.30-15.50: Using workshops with professionals and decision makers to implement solutions tailored for AYA pediatric brain tumour survivors (PBTS).

Marco Bonanno

15.50-16.10: The voices of breast cancer survivors with pain: an exploration of their experiences and perspectives about pain and its management

Chiara Filipponi

16.10-16.30: Quality of Life and Influencing Factors in Newly Diagnosed Oral Cancer Patients – A One-year Prospective Longitudinal Study

Yeur-Hur Lai

16.30-16.40: Towards an empirical model of FoP in advanced cancer patients receiving ongoing systemic treatment

Evie Kolsteren

16.40-16.50: Bibliotherapy program to improve emotional wellbeing during cancer treatment

Elizabeth Wells

16.50-17.00: Q&A

### ROOM 302

#### SYMPOSIUM

15.30-17.00: Minding the gap in cancer patients' care trajectory: a multidimensional and multidisciplinary perspective

*Chair: Gabriella Pravettoni, Carmen Criscitiello*

*Speakers: Rossana Berardi, Alessandra Milani, Ketti Mazzocco, Adriana Bonifacino, Francesco De Lorenzo*

*With the unconditional grant of Daiichi Sankyo*

### ROOM 304

#### New technologies

Moderator: Yvonne O'Meara

15.30-15.50: From the silent epidemic and its harm to digital therapeutic: narrowing the gap of unmet solicitude of anxiety and depression among cancer patients (experiences from SYSUCC)

Ze-Jiang Zhan



H.

15.30

-

17.00

15.50-16.10: The 'ACT now & check-it-out' intervention to support patient-initiated follow up (PIFU) for Head and Neck cancer patients – intervention development and feasibility study  
Lauren Matheson

16.10-16.30: IConnecta't 2 years later: Results and lessons learned from the implementation of a psychosocial eHealth ecosystem for breast cancer survivors  
Joan Carles Medina Alcaraz

16.30-16.40: An eHealth education program for breast cancer patients  
Laura Ciria-Suarez

16.40-16.50: Feasibility of Self-Hair-Sampling and the Relationship between Scalp Hair Cortisol and Perceived Stress in Cervical Cancer Survivors - a PROFILES Registry study  
Belle H. de Rooij

16.50-17.00: Q&A

### ROOM 309

SYMPOSIUM (Italian language only)

15.30-17.00: SIPO (Italian Society of Psycho-Oncology) position on: national law on Psycho-Oncology, core curriculum in Psycho-Oncology and academic training path of the Psycho-Oncologist

*Chair: Luigi Grassi*

*Speakers: Angela Piattelli, Luigi Grassi, Paolo Gritti*

### ROOM 422

#### Implementation science

Moderator: Geraldine McDonald

15.30-15.50: A mixed-method study of Stronger Together, a peer-to-peer psychosocial intervention for women with breast or gynecologic cancer  
Phuong Thao Le

15.50-16.00: Proposal for the inclusion of psycho-oncology in the care flow for patients undergoing oral antineoplastic treatment.  
Patricia Figueiredo

16.00-16.10: Online group psychoeducation for people with cancer referred to clinical psychology – a stepped-care model  
Fiona Lynch

16.10-16.20: Strategies for sustainability: Implementation insights for long-term sustainment of programs that routinely collect Patient Reported Outcomes (PROs) in cancer care clinical settings  
Carolyn Mazariego-Jones

16.20-16.30: Implementation of a nurse-led symptom screening program in routine oncology outpatient clinics for post-treatment cancer patients  
Wendy Wing Tak Lam

H.

15.30

-

17.00

16.30-16.40: Effectiveness of Mindfulness- Based Cognitive Therapy Program on Reduction of Stress Anxiety and Depression Symptoms Following Surgical Treatment for Ovarian Cancer Patients at Ubon Ratchathani Cancer Hospital, Thailand  
Sopit Tubtimhin

16.40-16.50: The Development of Cancer Genetic Counseling at Ubon Ratchathani Cancer Hospital, Thailand  
Chaliya Wamaloon

16.50-17.00: Q&A

### ROOM 433

#### SYMPOSIUM

15.30-17.00: Assessment and treatment of anxiety and depression in cancer patients

*Chair: Barbara Andersen*

*Speakers: Barbara Andersen, Julia Rowland, Maggie Watson*

### ROOM 435

#### SYMPOSIUM

15.30-17.00: Cancer Care Beacon - Reducing disparities across the European Union

*Chair: Denis Horgan*

*Speakers: Giulia Ferraris, Dario Monzani, Aline Machiavelli*

### ROOM 515

#### Cancer treatment-related symptoms and toxicity management

*Moderator: Gaia Giulia Angela Sacco*

15.30-15.50: Sexual rehabilitation for women with gynecological cancers receiving radiotherapy: preliminary results of a multi-center randomized trial of a nurse-led intervention  
Isabelle Suvaal

15.50-16.00: Two-year trajectories of sleep disturbance in cancer survivors following treatment completion  
Julia Chan

16.00-16.10: Cognitive rehabilitation and psychosocial intervention through a scalable digital ecosystem in breast cancer: a randomised clinical trial  
Maria Serra Blasco

16.10-16.30: Sleep-Now - Cognitive behavioral therapy and physical exercise in men with prostate cancer with insomnia: A feasibility randomized controlled trial  
Beverley Lim Høeg

16.30-16.40: My life turned upside down: Arab cancer survivors sexuality wellbeing  
Ibrahim Alananzeh

16.40-16.50: Perspectives of patients with metastatic breast cancer on exercise programs. Results from a survey study in five European countries.  
Martijn Stuiver

16.50-17.00: Q&A

H.

15.30

-

17.00

**ROOM 517****SYMPOSIUM**

15.30-17.00: Innovations in Symptom Assessment and Management in Rare Cancers and Beyond from the U.S. National Cancer Institute Center for Cancer Research (NCI-CCR)

*Chair: Terri S. Armstrong*

*Speakers: Alvina A. Acquaye-Mallory, Amanda L. King, Elizabeth Vera*

**ROOM MALLIANI****PANEL**

15.30-16.30: Nutrimental - all the taste of care

*Speakers: Vittorio Guardamagna, Grazia Armento*

*With the unconditional grant of Istituto Gentili*

**TALK SHOW**

16.30-17.15: Beauty cosmetic treatment and cancer: what can we do?

*"La forza e il sorriso - look good feel better Italia Onlus"*

*Chair: Emma Louise Crawley*

*Speakers: Anna Segatti, Florence Didier, Elisa Bonandini, Elisabeth Holzknecht*

17.30

**AULA MAGNA**

**Classical concert by the UNIMI Orchestra**

**Teofil Milenkovic, concert master and solo violin**

*Francesco Geminiani, Concerto Grosso op 5 n° 12 in re minore, "La Follia"*

*Antonio Vivaldi, Le quattro stagioni*

18.30



Cocktail reception in the University Courtyard

## SEPTEMBER 2

H.

08.30

-

10.00

### AULA MAGNA

#### SYMPOSIUM

08.30-10.00: The Emerging Role of Neuro-Immune Biomarkers in Psycho-Oncology

*Chair: Kim Youngmee*

*Speakers: Kim Youngmee, Yori Gidron, Johanna Czamanski-Cohen*

### ROOM 113

#### Environment, equity and economy

*Moderator: Giulia Ferraris*

08.30-08.50: Barriers to cancer treatment for people experiencing socioeconomic disadvantage in high-income countries: A scoping review.

Amber Bourgeois

08.50-09.10: Using an equity lens to consider organizational level barriers to accessing cancer care for people who are highly marginalized

Tara Horrill

09.10-09.30: Understanding the impact of distance and disadvantage on lung cancer care and outcomes: a qualitative interview study in urban and rural settings.

Daisy McInerney

09.30-09.50: The Challenges and Opportunities for Cancer Research and Cancer Care in Rural Settings

Ros Kane

09.50-10.00: Q&A

### ROOM 201

#### Caregivers' needs and interventions addressing them

*Moderator: Joanne Shaw*

08.30-08.50: Improvement of psychosocial well-being of onco-pediatric patients and of their caregivers enrolled in Una Nueva Esperanza's (UNE, Puebla, Mexico) support group intervention program

Ma del Rocio Banos-Lara

08.50-09.10: A mixed-method examination of financial distress in couples coping with metastatic breast cancer

Juliet Kroll

09.10-09.30: Taking care of the care giver: A transdisciplinary work model in palliative care family clinic

Yair Mor

09.30-09.50: Caregiver fear of cancer recurrence levels, measures, and associations: A systematic review and meta-analysis

Kyra Webb

H.

08.30

-

10.00

09.50-10.00: Emotion and Symptom-focused Engagement (EASE): Pilot Trial of a Psychosocial Intervention Adapted for Family Caregivers of Children Newly Diagnosed with Acute Leukemia  
Yu Ally

#### ROOM 208

##### Survivorship and quality of life

Moderator: Csaba Degi

08.30-08.40: Uncovering the complex role of social support in long-term adjustment to pediatric leukemia: an interpretative phenomenological analysis of experiences of young adult survivors  
Camille Bourdeau

08.40-08.50: Assessing quality of life in women with breast cancer  
Lovorka Brajkovic

08.50-09.00: Educational differences in impaired functioning and severe symptoms among 27,857 cancer survivors in Denmark  
Susanne Oksbjerg Dalton

09.00-09.10: Prevalence of loneliness and associations with health behaviours and BMI in 5835 people living with and beyond cancer (LWBC)  
Abi Fisher

09.10-09.20: A scoping review of post-treatment cancer survivorship care in Africa: Looking back to inform future practices  
Isaiah Gitonga

09.20-09.30: Identifying associations between demographics and fear of cancer recurrence as assessed by the Ottawa Clinical Fear of Recurrence -Measure (OCFR-M).  
Samantha Kempe

09.30-09.40: Different life experiences with multiple myeloma and gaps between patients and caregivers: 40 dyads in-depth interview  
Kim Sooyeon

09.40-09.50: Supportive Care Needs of Men diagnosed with Prostate Cancer and their Close Allies across Primary Treatment Modalities (The PCaN Study): A cross-sectional national registry-based study  
Carolyn Mazariego-Jones

09.50-10.00: Q&A

#### ROOM 211

##### Cancer treatment-related symptoms and toxicity management

Moderator: Stella Snyder

08.30-08.50: Prevalence and determinants of poor sleep quality in cancer survivors compared to a normative population: a PROFILES registry study  
Nicole Ezendam



H.

08.30

-

10.00

08.50-09.10: Household income, emotional concerns and help-seeking among adult survivors of cancer

Margaret Fitch

09.10-09.30: Prevalence of mental disorders in patients with newly diagnosed cancer in relation to socioeconomic status

Anja Mehnert-Theuerkauf

09.30-09.40: Health-related Quality of Life, Depression and Fear of Progression in Patients with Breast, Prostate, and Colorectal Cancer: Changes during Oncological Inpatient Rehabilitation and at a 9 Months Follow-up.

Juergen Giesler

09.40-09.50: Electronic Patient-Reported Outcomes (e-PROs) to improve the management and delivery of services coordinated across service levels and sites of care for lung cancer patients

Mona Magalhaes

09.50-10.00: Q&A

### ROOM 302

#### Palliative and end-of-life care

Moderator: Paolo Guiddi

08.30-08.40: Developing a bereaved-centred model of bereavement care for an Australian context

Laura Kirsten

08.40-08.50: The role of communication on attitudes towards Medical Assistance in Dying (MAiD) and the experience from the perspectives of patients with advanced cancer: A qualitative study

Olivia Mazzurco

08.50-09.00: Beyond the illness: exploring the multifaceted needs of bereaved parents following the death of their child to cancer

Anna Katharina Vokinger

09.00-09.10: What Does Meaning Mean?

Simon Wein

09.10-09.30: Supporting Patients and Spouses in Parenting their Young Children while Facing an Incurable Cancer: Results of a Pilot Trial

Kathrin Milbury

09.30-09.40: A review of the role of relatives in the legal frameworks and guidelines regarding assisted dying

Charlotte Boven

09.40-09.50: Relatives' needs in terms of bereavement care throughout a euthanasia: A qualitative study

Charlotte Boven

09.50-10.00: Q&A

H.

08.30

-

10.00

**ROOM 304****New technologies**

Moderator: Joan Carles Medina Alcaraz

08.30-08.40: Effectiveness of a Virtual Psycho-Oncology Clinic in Improving Acceptance of Disease: Utilizing a CBT Self-Management Model with Online Feedback  
Evgeniia Ananeva

08.40-08.50: A smartphone-delivered program to promote the Sexual Health of Colorectal Cancer Survivors (Anathema): Lessons learned from conducting a feasibility pilot randomized controlled trial  
Cristina Mendes-Santos

08.50-09.00: Grieving after palliative sedation: how to support the spouses.  
Yasmine Chemrouk

09.00-09.10: Electronic mental health alerting-responding system versus standard of care in managing anxiety and depression in nasopharyngeal carcinoma: a prospective, multicenter, randomized controlled, phase III trial in China (eMHARS protocol)  
Ze-Jiang Zhan

09.10-09.30: The effects of digital health care system (Cancer Manager®) on the management of psychological status and quality of life in patients with breast cancer  
Eun Kim

09.30-09.50: Effects of a Cognitive Behavioral Digital Therapeutic on Distress and Quality of Life in Patients with Cancer: A Decentralized Randomized Controlled Trial (RCT)  
Chloe Taub

09.50-10.00: Q&A

**ROOM 309****Implementation science**

Moderator: Franziska Springer

08.30-08.50: Scaling Up from One Cancer Center to Many: Adaptation of Empathic Communication Skills (ECS) Training to Reduce Lung Cancer Stigma  
Jaime Ostroff

08.50-09.10: Acceptability of the self-directed self-management intervention Coping-Together for Patients with Advanced Cancer and their Caregivers  
Sydney Wasserman

09.10-09.30: Update of the German evidence based guideline for psychosocial assessment, counselling and treatment of adult cancer patients  
Joachim Weis

09.30-09.50: Prismatic Coherence Model (PCM): Human Systems Modelling  
Jones Helene Markham

09.50-10.00: Q&A

H.

08.30

-

10.00

**ROOM 422****Ethics and decision making in cancer care**

Moderator: Anne Miles

08.30-08.50: Decision-making processes on medical aid in dying: scoping review and qualitative evaluation from multiple professional perspectives

Pola Hahlweg

08.50-09.10: Psychological assessment of the decision-making process in the oncofertility consultation for young cancer patients: preliminary data.

Letizia Lafuenti

09.10-09.30: Treatment Decision Making in Men with Early-Stage Prostate Cancer Eligible for Active Surveillance: Why do They Chose Active Treatment?

Christian Nelson

09.30-09.50: Communication, information needs and decision making in biomarker-driven oncology: A scoping review

Theresia Pichler

09.50-10.00: Q&amp;A

**ROOM 433****Assessment instruments and research methods in cancer care**

Moderator: Linda Sharp

08.30-08.40: Biofeedback Implementation in a Psychodynamic Consultation Model for Cancer Patients and their Caregivers

Marco Gonella

08.40-08.50: Diagnostic Performance of Screening Tools for Depressive Symptoms in Vulnerable Older Patients with Cancer Undergoing Comprehensive Geriatric Assessment (CGA): Results from the SCREEN Pilot Study

Laura Tack

08.50-09.10: Evaluating depression with psychomotor agitation in oncology patients: a focus on illness burden and suicidality

Alessio Simonetti

09.10-09.30: Evaluation of the validity and screening performance of a revised single-item fear of cancer recurrence screening measure (FCR-1r)

Allan 'Ben' Smith

09.30-09.50: Assessing quality of life with the SF-12: a comparison between three methods

Phuong Thao Le

09.50-10.00: Differentiating depression severities in cancer survivors using the PHQ-9 items; Item response theory approach

Kotone Hata

H.

08.30

-

10.00

**ROOM 435****Communication in cancer care**

Moderator: Ilaria Cutica

08.30-08.50: Developing a Radiation Therapy Talking Book for Indigenous cancer patients  
Lara Stoll

08.50-09.10: Determinants of patient enablement in cancer care: a multilevel regression analysis with 30 oncology wards  
Christian Heuser

09.10-09.30: Doctor-patient linguistic style matching, emotional language synchrony, and patients' satisfaction in online consultations for thyroid nodules  
Dario Monzani

09.30-09.40: "Teach for dignity": evaluation of training on dignity-in-care for nursing students conducted by a psycho-oncologist  
Loredana Buonaccorso

09.40-09.50: The importance of welcoming patients to the day hospital  
Juliana Vienne

09.50-10.00: Q&A

**ROOM 515****Health and disease in the people who care**

Moderator: Lucia Bonassi

08.30-08.50: Differences in mothers' and fathers' perception of family burden during their child's cancer  
Sonja Kälin

08.50-09.10: Who is caring for the carer? Supporting the wellbeing of the cancer carer in a Comprehensive Cancer Centre.  
Geraldine McDonald

09.10-09.30: Loss and Grief: Personal Stories of Doctors and Other Healthcare Professionals: Patients Can Only Be As Healthy As Their Healers (Edited by Matthew Loscalzo and Marshall Forstein; co-editor, Linda Klein)  
Matthew Loscalzo

09.30-09.40: "VITAL BREATH" PROJECT Taking care of cancer patients and family members through the practice of Tai Chi - Qi Gong combined with a psychological help group  
Federica Lo Dato

09.40-09.50: The AIL training model: a "path" to foster the well-being of the volunteer in order to enhance the quality of patient assistance  
Ilénia Trifirò

09.50-10.00: Q&A

H.

08.30

-

10.00

**ROOM 517****Cultures, countries, and international collaborations**

Moderator: Virginia Sanchini

08.30-08.50: Patient Voices: A Thematic Analysis of Stigmatizing Interactions Between Oncology Care Providers and Patients with Lung Cancer in Nigeria  
Chioma Asuzu

08.50-09.10: Cancer knowledge through the lens of older Latino men and women  
Tania Estapé

09.10-09.20: The experience of fear of cancer recurrence in Mexican breast cancer survivors: the role of the family  
Jorge Bazan Muñoz

09.20-09.30: Investigation of the Turkish Health Care Professionals' (HCPs) Evaluation of the Unmet Needs of the Patients in Türkiye (Turkey)  
Ozan Bahcivan

09.30-09.40: Supporting cancer patients who migrated from regions of the Middle East and are treated in "the West": Recommendations for Health Care Professionals for a cultural competence support derived from a Delphi-consensus.  
Alexander Wuensch

09.40-09.50: The IPOS ECHO: Disseminating Evidence-based Practices in Psycho-Oncology in Africa  
David Lounsbury

09.50-10.00: Q&A

**ROOM MALLIANI****Empirically supported treatments**

Moderator: Ilaria Durosini

08.30-08.50: Evidence based research on the effect of hypnosis as a psychological intervention in the care of breast cancer patients: A randomised prospective controlled study  
Éva Bányai

08.50-09.10: The reduction of emotional distress after psychological treatment reduces the risk of breast cancer recurrence in 5-year follow ups  
Cristian Ochoa Arnedo

09.10-09.30: Mitigating procedural pain in children using hypnosis-derived communication techniques: Skills acquisition and maintenance following training in Canadian professionals in hematology-oncology  
Serge Sultan

09.30-10.00: Q&A

10.00

-

11.00

**PLENARY SESSION****AULA MAGNA****PRESIDENTIAL PLENARY**

Chair: Tom Hack

How hard should we try? Evaluating implementation strategies for embedding an anxiety/depression clinical pathway into routine oncology practice.

**Phyllis Butow**

11.00



Break and poster discussion

H.

11.30

-

13.00

**AULA MAGNA****SYMPOSIUM**

11.30-13.00: Assessment of Fear of Progression and Fear of Cancer Recurrence: Instruments and results across the globe

Chair: José Custers

Speakers: Christine Maheu, Lauriane Giguère, Ana Torres

**ROOM 113****Health promotion and cancer prevention - Palliative care**

Moderator: Chioma Asuzu

11.30-11.50: Health behaviour advice and adherence to the World Cancer Research Fund recommendations among 5,835 adults living with and beyond cancer  
Rebecca Beeken

11.50-12.00: Personal, social and environmental factors determining tobacco use among school children in India  
Sundaramoorthy Chidambaram

12.00-12.10: Psychological, existential and spiritual dimensions of cancer patients in palliative care  
Samantha Serpentine

12.10-12.20: Shared decisions and autonomy; What is in the name? Results of a pilot study on breast cancer screening communication among Belgian couples and its future implication on screening policy  
Irfan Lone

12.20-12.30: Q&amp;A

**ROOM 201****SYMPOSIUM**

11.30-13.00: Improving Quality of Psycho-Oncology Care for Cancer Survivors through Publication and Dissemination of Innovative Research: Insights from Journal Editors

Chair: Larissa Nekhlyudov

Speakers: Brian Kelly, Wendy WT Lam, Penelope Damaskos, Larissa Nekhlyudov

H.

11.30

-

13.00

**ROOM 208****SYMPOSIUM**

11.30-13.00: Ensuring ethical and flexible consent in cancer genomic research and clinical practice

*Chair: Ilona Juraskova*

*Speakers: Phyllis Butow, Jolyn Hersch*

**ROOM 211****SYMPOSIUM**

11.30-13.00: Communicating With Older Adults With Cancer and Their Caregivers: Navigating Meaning And Emotion Among Diverse Populations of Older Patients, Caregivers, Healthy Older People and Healthcare Professionals

*Chair: Gil Goldzweig*

*Discussant: Lea Baider*

*Speakers: Youngmee Kim, Patricia A. Parker, Tania Estapé*

**ROOM 302****SYMPOSIUM**

11.30-13.00: Winning Stakeholders' Trust in Genomic Data Sharing through PsychoOncology to ensure the uptake of Next Generation Sequencing and the use of Real World Evidence

*Chair: Denis Horgan*

*Speakers: Fabrizia Galli, Michael Zaiac, Jasmina Koeva, Paolo Casali, Vanessa Witte*

**ROOM 304****SYMPOSIUM**

11.30-13.00: Understanding and Addressing the Needs of Adolescents and Young Adults with Cancer

*Chair: Suzanne Guerin*

*Speakers: Suzanne Guerin, Karen Neylon*

**ROOM 309****Survivorship and quality of life**

**Moderator: Christopher Recklitis**

11.30-11.50: What Comes Next? A Storybook for the Children of Cancer Survivors  
Sydney Wasserman

11.50-12.10: "Living with breast cancer during COVID-19": Roles of unmet supportive care needs, cancer care service disruptions, and COVID-19-related perception in psychological distress among recently-diagnosed breast cancer survivors in Hong Kong  
Nelson Yeung

12.10-12.30: Cancer patients' most burdensome problems – An analysis of routine data in a psycho-oncological out-patient facility  
Mareike Thomas

12.30-13.00: Q&A



H.

11.30  
-  
13.00**ROOM 422****AYA issues and interventions addressing their needs**

Moderator: Daniel Stark

11.30-11.50: Perceived sexual functioning before and after a cancer diagnosis in adolescence and young adulthood (AYA)

Vicky Lehmann

11.50-12.10: Feasibility of Videoconferenced Group-Based Support Programs for Adolescent Young Adults (AYAs) with Lymphoma

Stella Snyder

12.10-12.30: Psychotropic Medication in Pediatric Oncology for Acute Psychological and Psychiatric Problems: Balancing Risks and Benefits

Johanna Blom

12.30-13.00: Q&amp;A

**ROOM 433****SYMPOSIUM**

11.30-13.00: The effectiveness of innovative interventions for treating fear of cancer recurrence

Chair: Melanie P.J. Schellekens

Speakers: Louise Sharpe, Marije Van Der Lee, Pascale van der Wolf

**ROOM 435****SYMPOSIUM**

11.30-13.00: Developing a national Psycho-Oncology service in Ireland across the continuum of care

Chair: Helen Grealley

Speakers: Helen Grealley, Vicky Lunt, Louise Mullen

**ROOM 515****SPOTLIGHT LECTURE**

Chair: Gabriella Pravettoni

11.30-12.00: The emotional and cognitive aspects of pain: the role of the Psychologist

Speaker: Riccardo Torta

*With the unconditional grant of Roche*PANEL (in ITALIAN) \* **Accreditamento ECM per Psicologi e Oncologi**

12.00-13.00: mTNBC: Come stare veramente bene

Chair: Gabriella Pravettoni

Speakers: Giuseppe Curigliano, Ketti Mazzocco, Alessandra Milani, Rosanna D'Antona

*With the unconditional grant of Gilead***ROOM 517****SYMPOSIUM**

Psychosocial issues in cancer care: Italian multicenter studies from the Italian Society of Psycho-Oncology / Italian Society of Consultation-Liaison Psychiatry Working Groups

Chair: Luigi Grassi

Speakers: Rosangela Caruso, Federica Folesani, Luigi Grassi

13.00



Lunch and poster discussion

**13.30-14.00 AULA MAGNA**

IPOS General Meeting

14.00

-

15.00

**PLENARY SESSION****AULA MAGNA**

Chair: Ketti Mazzocco

14.00-14.15

Genomics and new trends in oncology

**Giuseppe Curigliano**

14.15-14.45

New Opportunities in Psycho-oncology: social regulation of the cancer genome

**Steven W. Cole**

14.45-15.00

Q&amp;A

14.00

-

15.00

**ROOM 302****ROUND TABLE**

14.00-15.00: Research in psycho-oncology: comparing Italy and abroad

*Chairs: Fabiola Bologna - Gabriella Pravettoni**Speakers: Lucia Bonassi - Laura Bozicevic - M. Novella Luciani - Anna Mancuso - Angela Piattelli*

15.00



Break and poster discussion

H.

15.30

-

17.00

**AULA MAGNA****SYMPOSIUM**

15.30-17.00: Work-related experiences and adverse work outcomes in rare cancer patients, their caregivers and health care professionals

*Chair: Saskia F.A. Duijts*

*Speakers: Saskia F.A. Duijts, Amber Daniëlle Zegers, Nanna Maria Hammer*

**ROOM 113****Implementation science**

**Moderator: TBD**

15.30-15.40: Behavioural swallowing therapy delivered during head and neck radiotherapy: pragmatic implementation strategies from clinician focus group  
Beatrice Manduchi

15.40-15.50: Feasibility of Routinely Measuring Psychosocial Outcomes of Primary Brain Tumor Patients in a Neuro-Oncology Clinical Setting  
Anjelica Body

15.50-16.10: Implementing patient-reported outcomes (PROs) in clinical practice: Patient perspectives of barriers and facilitators  
Mona Magalhaes

16.10-16.20: Implementation of the What Matters 2Adults (WM2A) wellbeing measure into cancer services in New South Wales  
Gail Garvey

16.20-16.30: Introducing Best Practice Guidance into Community Cancer Support Centres in Ireland  
Bernie O'Loughlin

16.30-16.50 Cancer control through sustainable alternate livelihood for beedi workers – An experience from India  
Surendra Veeraiah

16.50-17.00: Q&A

**ROOM 201****SYMPOSIUM**

15.30-17.00: The European Society of Medical Oncology (ESMO) Guidelines on psychosocial clinical conditions in cancer care: anxiety, depression, insomnia

*Chair: Luigi Grassi*

*Speakers: Luigi Grassi, Daniel McFarland, Luigi Grassi*

H.

15.30

-

17.00

**ROOM 208****Cancer treatment-related symptoms and toxicity management**

Moderator: Sydney Wasserman

15.30-15.50: Cancer-related Fatigue: Gaps between Guideline Recommendations and Clinical Practice as well as Psycho-Oncologists' Suggestions for Improvements  
Marlena Milzer

15.50-16.10: The cognitive effects of androgen deprivation therapy (ADT) in older men with prostate cancer on ADT for 1 to 3 years: A comparison study  
Christian Nelson

16.10-16.30: Identifying PTSD in Young Adult Cancer Survivors: Do DSM-5 Diagnostic Criteria Tell Us All We Need To Know?  
Christopher Recklitis

16.30-16.50: The dynamic interconnectedness of protective and perpetuating factors of cancer-related fatigue: Applying the network approach to intensive longitudinal data  
Melanie Schellekens

16.50-17.00: Q&A

**ROOM 211****Paediatric oncology issues and psychosocial interventions**

Moderator: Inese Lietaviete

15.30-15.50: Impact of the VIE study: A multimodule intervention to promote healthy diet and physical activity lifestyles in families confronted with childhood cancer  
Serge Sultan

15.50-16.10: Psychological distress in parents of long-term survivors of childhood cancer  
Gisela Michel

16.10-16.20: Caregiver Emotional Health and Adolescent Health Behaviors at the Completion of Treatment  
Rachel Webster

16.20-16.30: Child-centered Communication in Pediatric Oncology: A Scoping Review and New Communication Model  
Pernille Envold Bidstrup

16.30-16.40: Cognitive Functioning and Social Outcomes Among Survivors of Childhood Brain Tumour  
Tessa Chomistek

16.40-16.50: Factors Influencing Distress among Pediatric Cancer Patients in India  
Vidhya Gopalakrishnan

16.50-17.00: Q&A

H.

15.30

-

17.00

**ROOM 304****New technologies**

Moderator: Morgan Leske

15.30-15.50: EHealth intervention to manage symptoms of immunotherapy in patients with cancer (SOFIA): results of a randomized controlled pilot trial  
Christina Sauer

15.50-16.10: Report (of research) on the use of a psycho-oncology mobile phone app to support mental adaptation to diagnosis and treatment and evaluation of its effectiveness among patients with primary breast cancer  
Anna Syska-Bielak

16.10-16.30: Feasibility and preliminary efficacy of brief coaching calls in Healthy Living after Cancer Online: a randomised control trial  
Morgan Leske

16.30-17.00: Q&A

**ROOM 309****SYMPOSIUM**

15.30-17.00: The evolution of the Fear of Cancer Recurrence Therapy (FORT) intervention: To cultural adaptation to country-wide dissemination

*Chair: Christine Maheu*

*Speakers: Lizette Galvez-Hernandez, Jani Lamarche, Sophie Lebel*

**ROOM 422****Health promotion and cancer prevention - Psychoneuroimmunology and cancer survival**

Moderator: Luzia Travado

15.30-15.50: Assessing Anticipated Regret Related To Cervical Cancer And Preferences Regarding Methods Of Screening In Romanian Women  
Nicoleta-Monica Jiboc

15.50-16.00: Patient factors associated with the psychosocial outcomes of lung cancer screening: a systematic review  
Kathleen McFadden

16.00-16.20: The Impact of Genetic Predispositions to Depression on Quality of Life and Survival in Patients With Head and Neck Cancer Immediately Post-Treatment: A Longitudinal Study  
Melissa Henry

16.20-16.40: Does brain activity predict prognosis in cancer patients? Cancer may have a head  
Yori Gidron

16.40-17.00: Q&A

H.

15.30

-

17.00

**ROOM 433****Intervention models for specific cancer types**

Moderator: Giuseppe Deledda

15.30-15.50: Ensuring Brain Tumor Representation: Preliminary Open Pilot Trial Results of FearLess in Neuro-Oncology

Ashlee Loughan

15.50-16.10: Goal-focused Emotion-regulation Therapy (GET) in Young Adult Testicular Cancer Survivors: A Pilot Randomized Controlled Trial

Christian Nelson

16.10-16.30: A new model of psychoncological triage in Breast Cancer patients

Daniela Belella

16.30-16.40: Identifying determinants of adherence to endocrine therapy following breast cancer: a review of reviews

Linda Sharp

16.40-16.50: Effect of Motivational Interviewing Therapy on Adherence to Chemotherapy among Breast Cancer Patients in the North-central, Nigeria

Chioma Asuzu

16.50-17.00: Q&amp;A

**ROOM 435****Patient's advocacy and community care services**

Moderator: Matthew Loscalzo

15.30-15.50: Lived Experience of Black Women with Breast Cancer in Toronto, Canada

Ielaf Khalil

15.50-16.10: Impact of income on emotional concerns and help-seeking by cancer survivors 65+ years

Margaret Fitch

16.10-16.20: Cancer-Understanding Prevention in Intellectual Disabilities CUPID

Margaret Denny

16.20-16.30: Peer mentoring: How to integrate peers to support cancer patients in acute care or rehabilitation?

Joachim Weis

16.30-16.50: Down the rabbit hole: the rationale behind the diverse landscape of walk-in centers for cancer patients and their loved ones in Belgium

Nele Van den Cruyce

16.50-17.00: Q&amp;A

H.

15.30

-

17.00

**ROOM 515****Palliative and end-of-life care**

Moderator: Olivia Mazzurco

15.30-15.40: Improving the wellbeing of people with advanced cancer and their family carers: A study protocol of a hybrid effectiveness-implementation trial of an Australian dyadic digital health intervention (FOCUSau)  
Ilona Juraskova

15.40-15.50: AfterSedatio: the first study on risk assessment of bereaved partners in palliative care  
Yasmine Chemrouk

15.50-16.00: Exploration of Cancer Pain Management in Oncology Outpatient Services with Healthcare Professionals: A Qualitative Study  
Olivia Claire Robinson

16.00-16.20: From active to palliative care: preliminary data on emotional burden and self efficacy in patients and caregivers  
Letizia Lafuenti

16.20-16.40: Demoralization affects quality of life in terminally ill cancer patients  
Andrea Bovero

16.40-17.00: Q&A

**ROOM 517****Communication in cancer care**

Moderator: Ludovica Scotto

15.30-15.50: Didactic or narrative persuasion? An experiment on videos promoting colorectal cancer screening attendance.  
Giulia Scaglioni

15.50-16.10: Understanding human communication in cancer clinical trials: From patient pathographies to salutographies.  
Helene Markham-Jones

16.10-16.20: Development of a multidisciplinary tumor board for head and neck cancer  
Jessica Hamilton

16.20-16.30: Testing of Virtual Reality Truth-telling Communication Skill Training for Medical students in Taiwan  
Wroung-Ru Tang

16.30-16.50: Communication skills training for Radiation Therapists to improve Indigenous Australian cancer outcomes  
Lara Stoll

16.50-17.00: Q&A

H.

15.30

-

17.00

**ROOM MALLIANI**

SYMPOSIUM (ITALIAN)

**Orizzonti e prospettive dello psicologo nei contesti di salute, di prevenzione e di cura**

Chair: Gabriella Pravettoni

Moderator: Roberta Ferrucci

15.30-15.40: L'integrazione della formazione psicologica all'interno della formazione medico-sanitaria: l'esperienza dell'Università degli Studi di Milano

Gianluca Gaetano Vago

15.40-15.55: Come è cambiato il ruolo dello psicologo post pandemia: implicazioni e prospettive per la psicologia della salute

David Lazzari

15.55-16.10: Intelligenza Artificiale (IA) in psicologia: nuove frontiere tra prevenzione e cura

Guendalina Graffigna

16.10-16.25: Gli interventi a distanza, tra telepsicoterapia e testistica diagnostica e riabilitativa a distanza

Barbara Poletti

16.25-16.40: Lo psicologo nelle cure primarie: importanza della specificità formative pratico-cliniche nella definizione di ruoli e professionalità

Laura Parolin

16.40-17.00: Q&amp;A

17.15

**AULA MAGNA****FuckCancer Choir concert***Stay strong: the choir of those who never give up*

18.00

**JPORP reception**

20.30

**Social dinner**

Museo Nazionale della Scienza e della Tecnica



# SEPTEMBER 3

H.

08.30

-

10.00

## AULA MAGNA

### **Burn-out and interventions to reduce it in HCPs / Health and disease in the people who care**

Moderator: Luigi Grassi

08.30-08.50: The relationship between team resilience at work and work-related sense of coherence among healthcare professionals in oncology – a cross-sectional study  
Dominique Tremblay

08.50-09.10: Universal Leadership Skills in Supportive Care & Psycho-Oncology: Moving Beyond the Need for Being on Perpetual Life Support  
Juee Kotwal and Natale Schnaitmann

09.10-09.30: Stuck between youth and family life – an identification of adolescents' experiences and needs during their mother's breast cancer trajectory  
Anne Katrine Søby Hartmann

09.30-10.00: Q&A

## ROOM 113

### **Environment, equity and economy**

Moderator: Tara Horrill

08.30-08.50: Implementing the European Code of Cancer Practice in Rural and Remote European Settings  
David Nelson

08.50-09.10: Do immigrants know less than natives about cancer screening tests – the case of Netherlands  
Jelena Arsenijevic

09.10-09.30: Community-Based Participatory Research: Understanding How Women of the Global Majority in the United States Cope with Cancer  
Phillips Brenda Caldwell

09.30-10.00: Q&A

## ROOM 201

### **Cancer treatment-related symptoms and toxicity management**

Moderator: Mary Hughes

08.30-08.50: Prevalence of trauma and stressor-related symptoms and its impact on compliance to medical advice: a cross-sectional study among hematological cancer patients  
Franziska Springer

08.50-09.00: Predictors of quality of life and psychological functioning of patients participating in clinical trials of new drugs in advanced thyroid cancer.  
Anna Syska-Bielak

H.

08.30

-

10.00

09.00-09.10: Unmet care needs of patients with advanced cancer and their relatives: results of a multicenter observational study (eQuiPe)

Helen Driessen

09.10-09.20: Comparative Analysis of COVID-19 Pandemic Stress, Stress Management Resources (SMRs) and Quality of Life (QOL) for Persons with and without Cancer

Thomas Merluzzi

09.20-09.30: Psychological intervention for prostate cancer patients facing Penile prosthesis implantation

Ida Bolognini

09.30-09.40: Familism, Depression and Anxiety Among Latinos with Advanced Cancer from Puerto Rico and US

Rosario Costas-Muniz

09.40-09.50: Effectiveness of treatment for an adjustment disorder in cancer survivors: results of a Dutch nationwide study

Anne De Korte

09.50-10.00: Q&A

### ROOM 208

#### Survivorship and quality of life

Moderator: Viktorya Voskanyan

08.30-08.40: Determinants of subjective and objective cancer-related cognitive impairments among breast cancer patients.

Maria-Chidi Christiana Onyedibe

08.40-08.50: Quality of life assessment in childhood advanced cancer: development of self-reported versions of Advance QoL

Lye-Ann Robichaud

08.50-09.00: Functional Status and Quality of Life among Colorectal Cancer Survivors

Revathy Sudhakar

09.00-09.10: Physical and psychoeducation combined group intervention: Exploratory results

Ana Torres

09.10-09.30: Congruence of Dyadic Coping Behaviors among Rectal Cancer Patients and Their Partners: Implications for Emotional, Relational, and Sexual Health Outcomes

Chiara Acquati

09.30-09.50: The impact of cancer on psycho-social function and quality of life: A cross-sectional study in 18 pan-European countries

Svetlana Baziliansky

09.50-10.00: Q&A

H.

08.30  
-  
10.00**ROOM 211****Survivorship and quality of life**

Moderator: Linda Sharp

08.30-08.50: Positive and Negative Survivor-Specific Psychosocial Consequences of Childhood Cancer: The DCCSS-LATER 2 Psycho-Oncology Study  
Anne Maas

08.50-09.10: "It changes everything" Understanding how people experience the impact of living with a low-grade glioma  
Ben Rimmer

09.10-09.20: Fear of cancer recurrence among First Nations Australian breast cancer survivors  
Kate Anderson

09.20-09.30: What is the experience of consumers receiving and accessing cancer survivorship care across Victoria, Australia?  
Michael Jefford

09.30-09.40: Health professionals' priorities to enhance the delivery of survivorship care in Victoria, Australia  
Michael Jefford

09.40-10.00: Q&A

**ROOM 302****New technologies**

Moderator: Degi Csaba

08.30-08.40: The use of a remote video for psychosexual counseling  
Ludovica Scotto

08.40-08.50: Evaluating the feasibility of a co-designed, online healthy living intervention for post-treatment cancer survivors: Healthy Living after Cancer Online.  
Morgan Leske

08.50-09.10: Factors associated with intention to use tele-delivered supportive care among recently diagnosed breast cancer survivors during COVID-19 in Hong Kong: Applying the Unified Theory of Acceptance and Use of Technology  
Nelson Yeung

09.10-09.30: The Efficacy of an Age sensitive online program on psychosocial adaptation of Young Chinese Breast Cancer survivors  
Yun Hu

09.30-10.00: Q&A

H.

08.30

-

10.00

**ROOM 304****Palliative and end-of-life care**

Moderator: Florence Didier

08.30-08.40: ORPHYS – protocol of a feasibility study for short-term psychodynamic psychotherapy in serious physical illness  
Sigrun Vehling

08.40-08.50: Lessons learned from the development of a process evaluation as part of the DIAdIC international randomised controlled trial of two psychoeducational intervention for people with advanced cancer and their family caregivers  
Suzanne Guerin

08.50-09.00: Education for interpreters in palliative care: improving communication in culturally and linguistically diverse cancer patients  
Loredana Buonaccorso

09.00-09.10: Cannabis, the Art of Dissociation  
Simon Wein

09.10-09.30: Insecure attachment and death anxiety in incurable cancers: the mediating roles of intolerance of uncertainty and experiential avoidance  
Aliza Panjwani

09.30-09.50: Trajectories of Health-Related Quality of Life and Symptom Burden in Patients with Advanced Cancer towards the End of Life: Longitudinal Results from the eQuiPe Study  
Moyke Versluis

09.50-10.00: Q&A

**ROOM 309****New technologies**

Moderator: Serena Oliveri

08.30-08.40: Digital Therapeutic Alliance in a stepped psychosocial online intervention for cancer patients: Preliminary results of a multicentre randomised controlled trial  
Aida Flix-Valle

08.40-08.50: Who uses connected health technologies after cancer? Evidence from the Health Information National Trends Survey  
Isaiah Gitonga

08.50-09.00: A qualitative study on the feasibility and acceptability of a primary care intervention for fear of cancer recurrence  
Melanie Schellekens

09.00-09.10: Reducing psychological distress through the use of a audio-visual entertainment during whole-body MRI  
Lorenzo Conti

09.10-09.20: The online adaptation of managing cancer and living meaningfully (CALM) for patients and their family caregivers  
Alanna Chu

H.

08.30  
-  
10.00

09.20-09.30: Is it possible to digitalize the cancer rehabilitation team – Digi-CaRe from an idea to digi-clinical practice  
Patrik Göransson

09.30-09.40: Using collaborative, interdisciplinary and community engaged approaches to adapt a web-based intervention, Juntos Después del Cáncer (JDC), for Latina cancer survivors and their intimate partners  
Dinorah Martinez Tyson

09.40-09.50: Best practices for delivering written peer support to cancer patients undergoing stem cell transplant: Pros, cons, and patient and clinician feedback on a new website  
Christine Rini

09.50-10.00: Q&A

### ROOM 422

#### SYMPOSIUM

08.30-10.00: Championing our patients' psychological flexibility – innovative interventions from Acceptance and Commitment Therapy (ACT) in Psycho-oncology

*Chair: Christina Sauer*

*Speakers: Gregor Weissflog, Louise Hall, Francisco Garcia-Torres, Maria Karekla*

### ROOM 433

#### Intervention models for specific cancer types- Assessment instruments and research methods in cancer care

*Moderator: Ines Vaz-Luis*

08.30-08.40: Group ACT (Acceptance and Commitment Therapy), for breast cancer women: the usefulness of the Matrix method and Compassion based strategy.  
Giuseppe Deledda

08.40-08.50: The psychological intervention mediated by Photography on female cancer patients: the effectiveness on group vs individual setting  
Stefania Carnevale

08.50-09.00: Interplay between temperaments and depression severity and course in oncology patients  
Evelina Bernardi

09.00-09.10: Breast cancer survivors' unmet supportive care needs : psychometric assessment of the Portuguese version of the Supportive Care Needs Survey Short-Form (SCNS-SF34) and the breast cancer module (SCNS-BR8)  
Cristina Mendes-Santos

09.10-09.20: Determining the trajectory of changes in health-related quality of life and unmet needs among thyroid cancer patients: results of a systematic review  
Harriet Morris-Baguley

09.20-09.30: Q&A

H.

08.30

-

10.00

**ROOM 435****Paediatric oncology issues and psychosocial interventions - AYA issues and interventions addressing their needs**

Moderator: Pernille Envold Bidstrup

08.30-08.50: Symptom distress and physical activity of children and adolescents with cancer: A Latent profile analysis

Yanyan Liu

08.50-09.10: Psychoncological interventions on different level of trauma among children and adolescents with cancer and their parents

Giulia Zucchetti

09.10-09.20: Late Effects in Childhood Cancer Survivors in Kenya

J.P.M. (Jesse) Lemmen

09.20-09.30: Towards a new model of personalized multidisciplinary care for children with cancer and their families

Inese Lietaviete

09.30-09.40: Comparison of hyperactivity between survivors of childhood Acute Lymphoblastic Leukemia (ALL) and solid tumours.

Kaelyn McDonald

09.40-10.00: Q&A

**ROOM 515****AYA issues and interventions addressing their needs**

Moderator: Stella Snyder

08.30-08.50: Comparison of loneliness among cancer patients with minor children before and during the COVID-19 pandemic: an online cross-sectional survey

Kazuhiro Kosugi

08.50-09.10: The Swedish digital Promoting Resilience in Stress Management (PRISM) targeting adolescent and young adults newly diagnosed with cancer – An evaluation of a feasibility intervention study

Jeanette Winterling

09.10-09.20: Evidence- and Experience-based Recommendations for Meeting the Needs of Adolescents and Young Adults with Cancer using Therapeutic Recreation

Suzanne Guerin

09.20-09.30: Examining the Experiences of Underrepresented and Marginalised Groups in the Adolescent & Young Adult Cancer Population in Ireland

Suzanne Guerin

09.30-09.40: Social support and unmet age-tailored specific information needs throughout the AYA cancer trajectory

Carla Vlooswijk

H.

08.30

-

10.00

09.40-09.50: Pain Predicts Next Day Fatigue in Adolescents and Young Adults Receiving Maintenance Treatment for Acute Lymphoblastic Leukemia  
Kimberly Klages

09.50-10.00: Q&A

**ROOM MALLIANI**

**Rare cancers**

Moderator: Maria Thomson

08.30-08.50: Blind spots in the hematological cancer pathway: A narrative study about supporting and caring for patients  
Karine Bilodeau

08.50-09.10: Rare cancer patients: interaction patterns and preferences  
Katelijne Sanctorum

09.10-09.20: Q&A

10.00

-

11.00

**PLENARY SESSION****AULA MAGNA****Making decisions: the best solution for patients and oncologists**

Chair: Gabriella Pravettoni

10.00-10.15

How to promote self management and patient empowerment?

**Ines Vaz-Luis**

10.15-10.30

Choices are the hinges of destiny: how do we make good choices in the complex world of cancer?

**Andreas Charalambous**

10.30-10.45

Instruments for leveraging the wisdom of interdisciplinary teams

**Matthew Loscalzo**

10.45-11.00

Q&amp;A

*With the unconditional grant of Eli Lilly*

11.00



Break and poster discussion

H.

11.30

-

13.00

**AULA MAGNA****SYMPOSIUM**

11.30-13.00: Quality of Life in Oncology: measuring what matters for cancer patients and survivors in Europe (EUonQoL)

Chair: Roberto Grasso

Speakers: Cinzia Brunelli, Diana Sala, Olatz Garin, Aline Machiavelli, Chiara Marzorati

**ROOM 113****SYMPOSIUM**

11.30-13.00: Psychological management of anxiety and depression in cancer patients

Chair: Xiaohong Liu

Speaker: Xiaohong Liu, Ran Zhou, Desong Yang

**ROOM 201****SYMPOSIUM**

11.30-13.00: From guideline development to improved practice. Making the journey faster, fairer and fit for purpose

Chair: Bogda Koczwara

Speakers: Bogda Koczwara, Eida Castro, Phyllis Butow

**ROOM 208****SYMPOSIUM**

11.30-13.00: Improving Interpersonal Communication in Cancer Care: Addressing the Psycho-Social Needs of Patients and Caregivers from Diverse Culture Backgrounds And Underserved Populations.

Chair: Gil Goldzweig

Speakers: Ilanit Hasson-Ohayon, Michal Braun, Simone Cheli, Emi Takeuchi



H.

11.30

-

13.00

**ROOM 211****SYMPOSIUM**

11.30-13.00: CaLM Psychotherapy for advanced cancer patients and their caregivers: data across different cultures

*Chair: Rosangela Caruso*

*Speakers: Rosangela Caruso, Froukje de Vries, Luzia Travado*

**ROOM 302****SYMPOSIUM**

11.30-13.00: Towards implementation of evidence-based interventions for fear of cancer recurrence: Real world settings and outcomes

*Chair: Louise Sharpe*

*Speakers: Christine Maheu, José A.E. Custers, Gaynor Blankley*

**ROOM 304****SYMPOSIUM**

11.30-13.00: The managers' perspective during return to work of cancer survivors: what do we know, and what do we have to learn?

*Chair: Michiel A. Greidanus*

*Speakers: Michiel A. Greidanus, Karine Bilodeau, Bertrand Porro*

**ROOM 309****SYMPOSIUM**

11.30-13.00: Supporting Childhood Cancer Survivors Who Have Neurocognitive Impacts

*Chair: Kathy Ruble*

*Speakers: Lisa Northman, Clifton P. Thornton, Lisa Jacobson*

**ROOM 422****Ethics and decision making in cancer care**

**Moderator: Letizia Lafuenti**

11.30-11.50: Piloting and usability testing of a PDA for cancer patients with anxiety and depression to guide psycho-oncology treatment decisions

Joanne Shaw

11.50-12.10: Deciding to have breast reconstruction after mastectomy: what information do women want?

Victoria White

12.10-12.20: Implementing universal distress screening for cancer patients in Taiwan: obstacles and strategies

Chihtao Cheng

12.20-12.30: Coping with modesty and nudity during radiotherapy for breast cancer: a multicentric study

Loredana Dinapoli

12.30-12.45: Q&A

H.

11.30

-

13.00

**ROOM 433**

## SYMPOSIUM

11.30-13.00: Cancer screening and prevention in people with intellectual disabilities

*Chair: Margaret Denny**Speakers: Maarten Cuypers, Peter Knapp, Oliwia Kowalczyk***ROOM 515**

## SYMPOSIUM

11.30-13.00: Psycho-oncology in Ibero-America: achievements, challenges and future perspective

*Chair: Martha Paredes**Speakers: Lourdes Ruda, Rosario Costas-Muñiz, Tania Estapé***ROOM 517**

## SYMPOSIUM

11.30-13.00: Dignity and Dignity Therapy: the experience of the Italian Network on Dignity-in-Care (NiDI)

*Chair: Luigi Grassi**Speakers: Andrea Bovero, Loredana Buonaccorso, Federica Folesani***MALLIANI**

## SYMPOSIUM

11.30-13.00: Decision fatigue, burnout and workforce resilience in oncologists' clinical practice

*Chair: Elisabetta Munzone**Speakers: Giuseppe Curigliano, Ketti Mazzocco, Gabriella Pravettoni, Alessandra Milani, Andreas Charalambous, Csaba Degi, Gianluca Vago**With the unconditional grant of AstraZeneca*

13.00



Lunch and poster discussion

13.30

**PLENARY SESSION****AULA MAGNA**

Awards presentations

1. Arthur M. Sutherland Award and Memorial Lecture
2. Bernard Fox Memorial Award
3. Jimmie Holland Memorial Award
4. Hiroomi & Setsuko Kawano New Investigator Award
5. Noemi Fisman Award for Lifetime Clinical Excellence
6. Andrea Patenaude IPOS Scholarship

14.30

**AULA MAGNA****Highest ranked abstracts**

Moderator: Tom Hack

14.30-14.50: Medical Assistance in Dying in Canada and Suffering: Multi-Phase Study to Improve MAiD Education, Practice Guidelines and Plan a Research Agenda

Melissa Henry

14.50-15.10: The Supporting Our Carers Study: Developing a measure to assess the supportive care needs of caregivers of Indigenous Australians with cancer

Rachael Jaenke

H.

15.15

-

16.45

**ROOM 113****Survivorship and quality of life**

Moderator: Revathy Sudhakar

15.15-15.25: The Complexity of Body Image in Adolescent and Young Adult Cancer Survivors: A Qualitative Study

Alana Ireland

15.25-15.35: The development of clinical recommendations to improve experiences of chronic pain after cancer treatment for people living with and beyond cancer

Julie Armoogum

15.35-15.45: Online support for breast cancer patients: the experience of the FORT-based follow-up program in the virtual psycho-oncology clinic

Evgeniia Ananeva

15.45-15.55: Sexual Dysfunction and Sexual Inactivity in Survivors of Pediatric Central Nervous System (CNS) Tumors: A Project REACH Study

Lydia Chevalier

15.55-16.05: Improving emotion regulation in breast cancer patients in the early survivorship period: Attentional and psychophysiological changes associated with a brief ecologically boosted group intervention

Pauline Waroquier

16.05-16.15: Getting back on track after treatment of cancer: a qualitative interview study of cancer survivors' experiences

Marjolein Lugtenberg

H.

15.15

-

16.45

16.15-16.35: Towards personalized supportive care for cancer survivors: a qualitative study on the perceptions of cancer survivors and oncological healthcare professionals  
Margot Joosen

16.35-16.45: Q&A

### ROOM 201

#### Cancer treatment-related symptoms and toxicity management

Moderator: Elisabetta Munzone

15.15-15.35: A systematic review of evidence for the prevalence and severity of chronic bowel symptoms following pelvic radiotherapy.  
Adam Biran

15.35-15.55: Trajectories of Quality of Life during the hematopoietic stem cell transplantation  
Marta Pawełczak-Szastok

15.55-16.05: Lung cancer-specific symptoms and fear of cancer recurrence among recurrence-free non-small cell lung cancer survivors  
Genehee Lee

16.05-16.15: Cognitive performance of patient candidates to neoadjuvant chemotherapy and its relationship with psychosocial variables  
Veronica Neri-Flores

16.15-16.25: The PLISSIT model as an intervention tool for benefits in the sexual Quality of Cancer patients: an integrative review  
Giovana Zaparoli de Oliveira

16.25-16.45: Patient-Family Caregiver Concordance of Symptom Assessment for Esophageal Cancer Patients Undergoing Esophagectomy  
June Zhang

### ROOM 208

#### Survivorship and quality of life

Moderator: Grasso Roberto

15.15-15.35: Characteristics and components of self-management interventions for improving quality of life in cancer survivors: a systematic review  
Linda Sharp

15.35-15.45: Efficacy of the Framed Portrait Experience on Psychological Health Outcomes of Breast Cancer Survivors: Early Evidence within an Italian Sample  
Denise Vagnini

15.45-15.55: Psychosocial factors associated with quality of life in cancer survivors: an umbrella review.  
Viktorya Voskanyan

15.55-16.05: A combined physical and psychological program for the promotion of quality of life after cancer: a pilot study  
Valeria Seabri

H.

15.15

-

16.45

16.05-16.15: Measuring incompatibilities between areas of life in cancer survivors – development and first results of the INCOMPAT-CS instrument  
Kati Hiltrop

16.15-16.45: Q&A

#### ROOM 211

##### New Technologies

Moderator: Milija Strika

15.15-15.35: IMAGene. Epigenomic and machine learning models to predict Pancreatic Cancer in High Risk asymptomatic subjects  
Serena Oliveri

15.35-15.55: Digital Interventions for sexual functioning in breast cancer survivors: A protocol with a brief blended psychological intervention  
Ludovica Scotto

15.55-16.15: Psycho-oncologists' experiences with video consultations during the Covid-19 pandemic and implications for the future – a mixed methods study.  
Isabelle Scholl

16.15-16.30: Q&A

#### ROOM 302

##### SYMPOSIUM

Trust in oncology

*Chair: Daniel McFarland*

*Speakers: Daniel McFarland, Michelle Riba, Luigi Grassi*

#### ROOM 309

##### SYMPOSIUM

15.15-16.45: An interdisciplinary ecosystem for the psychosocial and behavioral management of Cardiotoxicity in elderly breast cancer patient: the CARDIOCARE project

*Chair: Fotiadis Dimitrios*

*Speakers: Anastasia Constantinidou, Gaia Giulia Angela Sacco, Kostas Tsiouris*

#### ROOM 422

##### SYMPOSIUM

15.15-16.45: Clinical Spiritual Care and Psychosocial Supports for Cancer Survivors and Their Families

*Chair: Lemeng Zhang*

*Speakers: Ran Zhou, Fei Tong, Lemeng Zhang*

#### ROOM 433

##### Others

Moderator: David Nelson

H.  
15.15  
-  
16.45

15.15-15.25: Cancer as a bad object – a case study of a Jungian trauma focused intervention of a cancer patient  
Ágnes Anna Kovács

15.25-15.35: Breastfeeding after cancer: a national survey  
Francesca Dionigi

15.35-15.45: What’s behind the label: How advanced lung cancer patients receiving immuno- and targeted therapy label themselves  
Sophie Lebel

15.45-16.05: Perceived discrimination (PD) and quality of life (QOL) for African American (AACP) and Caucasian American (CCP) cancer patients: A qualitative and mediation analysis of micro- and macroaggressions and coping mechanisms  
Thomas Merluzzi

16.05-16.25: Identify suicide risk factors of cancer patients according to their first 2-year treatment  
Yung-Chih Chiang

16.25-16.45: Q&A

**ROOM 515**

**SYMPOSIUM**

15.15-16.45: Equity in eHealth in cancer care – developing accessible resources for the public and patients

*Chair: Claire Foster and Tania Estapé*

*Speakers: Kate Morton, Eveline M.A. Bleiker, Ellen Engelhardt*

16.45

**PLENARY SESSION**

**AULA MAGNA**

IPOS 2024 official announcement and Closing remarks

# Peripheral Meetings Schedule

## SEPTEMBER 1

10 to 10:30 a.m.	Education Committee	Room 113
10 to 10:30 a.m.	Fundraising and Marketing Committee	Room 433
10 to 10:30 a.m.	Palliative Care	Room 311
15 to 15:30 p.m.	Cancer and Aging: Reflection for Elders (CARE)	Room 113
15 to 15:30 p.m.	Latin American/Spanish Special Interest Group (LASSIG)	Room 433
15 to 15:30 p.m.	Fear of Cancer Recurrence Special Interest Group (FORwards)	Room Malliani

---

## SEPTEMBER 2

11 to 11:30 a.m.	Early Career Professionals in Psycho-Oncology (ECPP) Committee	Room 113
11 to 11:30 a.m.	e-Health	Room 433
11 to 11:30 a.m.	Survivorship	Room Malliani
15 to 15:30 p.m.	World Congress Committee	Room 113
15 to 15:30 p.m.	Federation Committee	Room Malliani

---

## SEPTEMBER 3

11 to 11:30 a.m.	Research committee	Room Malliani
11 to 11:30 a.m.	Pediatric	Room 433
11 to 11:30 a.m.	Low and Medium Income Countries (LMIC)	Room 113

---

# General information



## Congress Venue

Università degli Studi di Milano  
Via Festa del Perdono 7  
20122 Milano

How to get to the congress venue:

**Buses** 54, 60, 73, 84, 94

**Trams** 12, 14, 15, 16, 23, 24, 27

**Metro** Red line #1 -> station Duomo

Yellow line #3 -> stations: Missori, Duomo



## Official Language

English, with the exception of few symposia, that will be held in Italian (no translation provided)



## Badges

All registered participants, speakers and exhibitors will be given a badge, which they must mandatorily wear within the congress areas.



## Social Programme

**September 1, 5.30 PM - Aula Magna**

Welcome concert performed by the Orchestra of the Università degli Studi di Milano followed by a welcome cocktail

**September 2, 5.15 PM - Aula Magna**

FuckCancer Choir concert

followed by a light cocktail offered by the IPOS Journal

**September 2, 8 PM - Museo della Scienza e della Tecnica**

Social dinner

The attendance is optional and on payment. Tickets can be collected at the registration desk



## Wifi

A free wifi is available in all the meeting rooms and common areas.



## Registration Hours

**Psycho-social Academy**

Thu, August 31, from 8 AM

## 24th IPOS World Congress

Thu, August 31, from 4 PM to 5 PM

Fri, September 1, from 7.30 AM to 5.30 PM

Sat, September 2, from 8 AM to 5.30 PM

Sun, September 3, from 8 AM to 2 PM



## Posters

Posters will be displayed on poster boards, located in the Congress Venue (see maps on pages 60-61)

Posters will be numbered and must be exposed for the whole duration of the congress. In order to encourage discussion poster presenters should be at the assigned poster panel during the breaks.



## Oral Presentations

Oral presenters must upload their slides in the online platform prior to the congress. The link will be sent by the organising secretariat directly to all the presenters. In addition, presenters must bring their own slides on a USB drive key. No presentations from laptops will be allowed.



## Course Regulations

It is strictly forbidden to take pictures or film the slide and video presentations, in all the meeting rooms. Smoking is not permitted in all the conference areas.



## Certificate of Attendance

Certificates of attendance will be sent by email to all registered attendees after the end of the congress.



## Weather

The temperature in summer is normally very warm, around 25/30°C.



## Congress Map

# CONGRESS MAP

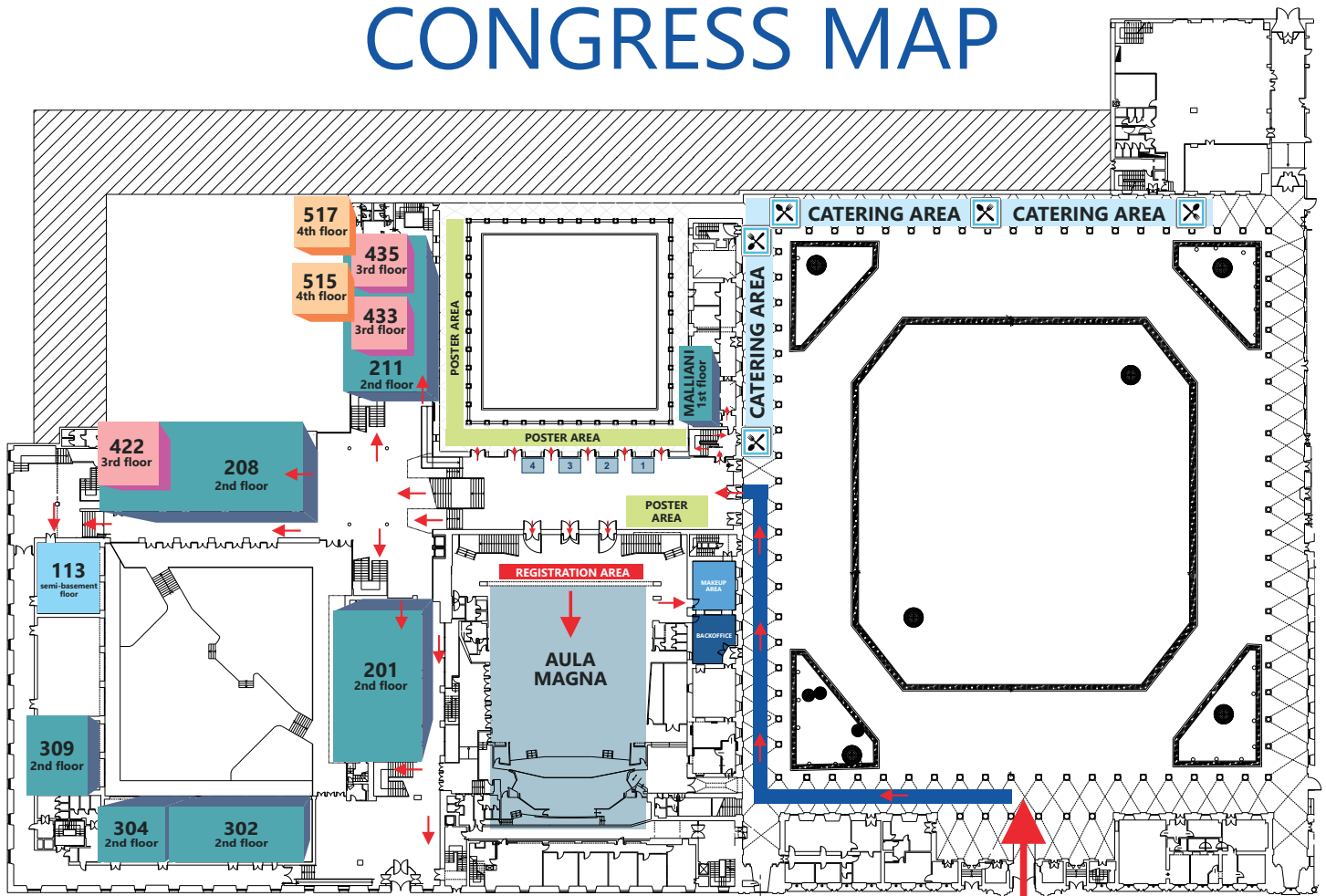

**MAIN ENTRANCE**

Via Festa del Perdono 7, Milano

## Congress and Poster area map

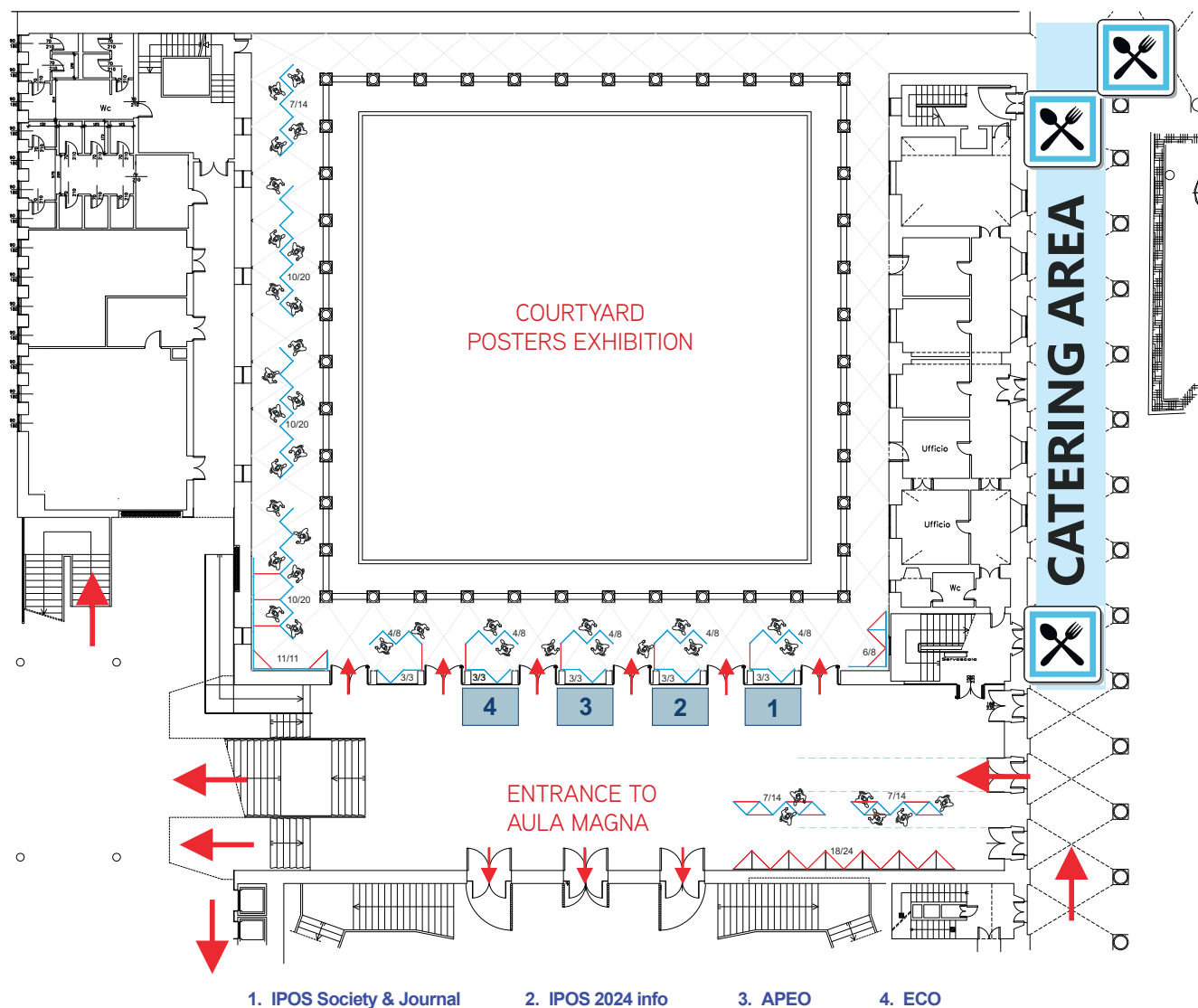

# Endorsements

PATROCINIO

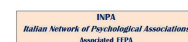



# MILAN, ITALY

AUGUST 31 - SEPTEMBER 3, 2023

[www.ipos2023.org](http://www.ipos2023.org)

#### Congress venue

Università degli Studi di Milano  
Via Festa del Perdono 7  
20122 Milano, Italy



UNIVERSITÀ  
DEGLI STUDI  
DI MILANO



#### Organising secretariat

MZ Events Srl  
Via Carlo Farini 81 - 20159 Milano, Italy  
Ph. +39 0266802323 - ext. 902  
[ipos2023@mzevents.it](mailto:ipos2023@mzevents.it)  
P.IVA/VAT-IT 05106600157 - SDI: WHP7LTE